

**SOUTHERN POWER DISTRIBUTION COMPANY OF A.P. LIMITED
TIRUPATI**

Memo.No.CGM/P&MM. & IPC/SPDCL/TPT/CIVIL/F.210/D.No. 501/16 dt. 19-02-2016

Sub: SPDCL – Consolidated SPDCL SSR for the year 2015-16 – Issued – Reg.

Ref :- Note orders dated 28-01-2016 of Chairman & Managing Director APSPDCL

With reference to the note orders dated 28-01-2016, the rates of SSR 2014-15 are revised and new SSR for the year 2015-16 is finalized. This SSR is effective from the date of issue.

Finalized copy of SSR is being sent through e-mail to all Chief Engineers/ Superintending Engineers/Divisional Engineers/Executive Engineers/Assistant Divisional Engineers/ Assistant Engineers/ Additional Assistant Engineers for implementation in the SPDCL from now onwards.

Encl: Copy of SPDCL
SSR 2015-16.

**Sd/-K.SANTHOSHA RAO
CHIEF GENERAL MANAGER
P&MM & IPC
APSPDCL :: TIRUPATI**

To

All Superintending Engineers/ Operation/SPDCL
All Executive Engineer / Civil /APSPDCL, Tirupati.
All Divisional Engineers/ Operation/ SPDCL
All Divisional Engineers/ Transformers/ SPDCL
All Divisional Engineer/ M&P/ SPDCL
All Divisional Engineers/ Construction/SPDCL
All Asst Div. Engineers/ Operation/ SPDCL
All Assistant Engineers & Addl. Asst. Engineers/ Operation/ SPDCL

Copy to

The Chief Engineer/ Zone/ SPDCL/ Tirupati , Vijayawada & Kurnool.
The Chief General Manager/ Planning/ SPDCL/ Tirupati.
The Chief General Manager/ Projects/ SPDCL/ Tirupati.
The Chief General Manager/ Opn./ SPDCL/ Tirupati.
The Chief General Manager/Expenditure/SPDCL/ Tirupati.
The Superintending Engineer / Civil/ Corporate Office/SPDDL/Tirupati
The Superintending Engineer / Civil/ SPDDL/Vijayawada
The Superintending Engineer / DPE/ SPDDL/Tirupati
The Superintending Engineer / Assessments/ SPDCL/Tirupati.
The Divisional Engineer/ DPE/ SPDCL
The Divisional Engineer/ Assessments/ SPDCL
Copy submitted to Peshi of Director/ Tech&HRD/ SPDCL/ Tirupati.
Copy submitted to Peshi of Director/Finance/ SPDCL/ Tirupati.
Copy submitted to Peshi of Chairman & Managing Director/ SPDCL/ Tirupati.

FORWARDED BY ORDER

EXECUTIVE ENGINEER/CIVIL

SOUTHERN POWER DISTRIBUTION COMPANY OF ANDHRA PRADESH LIMITED



COMMON STANDARD SCHEDULE OF RATES FOR THE YEAR 2015 - 2016

INDEX

Description	Page No.
I. Rates of Labour	1-2
II. Important note	3
III. Rates of Works	4-23
IV. Loading & Unloading Charges	24-27
V. Transport Charges	28-46

I. RATES OF LABOUR

Sl No.	Type of Labour	Unit	Rate
1)	First Class:-		
a)	Mason/ Brick Layer/Carpenter/ /Welder/Fitter/ /Mechanic	Day	420.00
b)	Painter/Plumber/ Electrician(Licensed)	Day	480.00
2)	Second Class - Mason/ Brick Layer/Carpenter/ Painter/Plumber/Welder/Fitter/Electrician/Mechanic	Day	375.00
3)	Un-Skilled Work Men/Women	Day	320.00
	AREA ALLOWANCES :-		
	A. CORPORATIONS & MUNICIPALITIES:-		
	a) i) 25% extra over the rates on labour component of works is allowed in all Municipal Corporation Limits except Vijayawada Municipal Corporations (<i>up to a belt of 12 Kms. from Municipal Corporation limits</i>) and other Corporations as notified by the Government from time to time.		
	ii) 40% extra over basic rates on labour component of works for Vijayawada Municipal Corporations (<i>Up to belt of 12 Kms from Municipal Corporation limits</i>).		
	b) Allow 20% extra over basic rates on labour component of works in all District Head Quarters and the remaining Municipal limits (<i>up to a belt of 12 Kms from Municipal limits</i>).		
	c) For works at Tirumala Hills in Chittoor District, 40% extra over the basic rates of labour component is allowed.		
	d) For works at Horsely Hills in Chittoor District, 30% extra over the basic rates of labour component is allowed.		
	B. Jail Compounds: 20 % extra		
	C. .INDUSTRIAL AREA:- Allow 20% extra over rates on labour component of works in the following Industrial Areas. (<i>within 10 Kms belt of Industrial area</i>)		
	KRISHNA DIST.- Ibrahimpatnam Distribution, Vuyyuru Distribution, Jaggaiahpetta Distribution.		
	GUNTUR DIST.- Macherla Distribution, Gurajala, Distribution, Dachepalli Distribution, Piduguralla Distribution		
	ONGOLE DIST.- Cheemakurthy Distribution, Maddipadu Distirbution		
	NELLORE DIST.- Tada Distribution, Muthhukur Distribution, Chillakur Distribution, Menakur Distribution, Kodavalur Distribution		
	CHITTOOR DIST.- Renigunta. Distribution, Gajula Mandyam distribution, Kuppam Distribution, Satyavedu Distribution,		
	KADAPA DIST.- Yerraguntla Distribution, Mangampeta Distribution, Jammalamadugu Distribution		
	ANANTAPUR DIST:- Hindupur Distribution, Tadipatri Distribution, Anantapur Distribution, Guntakal Distribution,		

	Rayalcheruvu Distribution, Yadiki Distribution		
	KURNOOL DIST :- Adoni Distribution, Dhone Distribution, Cement Nagar Distribution, Nandyal Distribution, Kurnool Distribution, Yemmiganur Distribution & Bethamcherla Distribution		
	NOTE:- If more than one area allowance(Such as those) for (1) Corporations (2) Municipalities and District Head Quarters (3) Industrial Area are applicable for a particular situation, only the maximum out of the allowable percentages is to be allowed.		

II. IMPORTANT NOTE

- (1) Specific approval is to be taken from the corporate office in respect of blasting works.
- (2) Extra percentage is not allowed for LC Period works/ shut down period works.
- (3) 9.1m/280 Kg Poles shall be utilised in Towns and 33 KV lines only.
- (4) All Fabrication works should be done by using departmental materials within stores Yard/premises only. Department materials shall not be issued to the out side the stores for fabrication purpose. Divisional Engineer/Tech shall personally monitor the issue of fabrication of materials.
- (5) All the estimates shall be prepared based on the rates of SSR only. For the items not covered in the SSR, approval is to be taken from the concerned SE, Operation.
- (6) Pole pit concreting is normally not allowed for PSCC/Spun poles. If concreting is to be done in certain cases, then specific approval is to be taken from the concerned SE, Operation.
- (7) Basic/Bed concreting is necessary for spun poles, if pole pit concreting is allowed.
- (8) Red oxide primer painting is not allowed in respect of old structures/equipment in 33/11 KV SS. Only one coat of aluminum/synthetic/ black bitumen paint is allowed.
- (9) No extra percentage/rate towards area allowance in respect of (a) loading & unloading charges (b) Fabrication of line materials (c) Dismantling and re-erection of Single Phase/Three Phase services is allowed

III. RATES OF WORKS

Sl No.	SAP Service code	Description	Unit	Rate
		EXCAVATION OF PITS		
1)		Excavation of pits in all soils i.e., mixture of gravel and soft disintegrated rock like shales ordinary gravel, stoney earth and earth mixed with fair sized boulders.		
a)	SSR00001	2' x 2'6" x 5' or 0.6m x 0.75m x 1.5m (for 8m or 9.1m PSCC poles)	Pit	230.55
b)	SSR00002	2' x 2'6" x 5'6" or 0.6m x 0.75m x 1.65m (for 10m Joists/ rail poles)	Pit	244.70
c)	SSR00003	3' x 3' x 6' or 0.9m x 0.9m x 1.8m. (for 11m spun/Joist poles)	Pit	270.80
d)	SSR00004	3' x 3' x 7' or 0.9m x 0.9m x 2.1m. (for 12.5 spun poles)	Pit	312.10
2)		Excavation of pits in excavation in soft disintegrated rock removable by pick axes		
a)	SSR00005	2' x 2'6" x 5' or 0.6m x 0.75m x 1.5m (for 8m or 9.1m PSCC poles)	Pit	257.70
b)	SSR00006	2' x 2'6" x 5'6" or 0.6m x 0.75m x 1.65m (for 10m Joists/ rail poles)	Pit	270.80
c)	SSR00007	3' x 3' x 6' or 0.9m x 0.9m x 1.8m. (for 11m spun/Joist poles)	Pit	299.00
d)	SSR00008	3' x 3' x 7' or 0.9m x 0.9m x 2.1m. (for 12.5 spun poles)	Pit	338.20
3)		Excavation of pits in hard rock by blasting Note:- 1) Specific approval is to be taken from the corporate office in respect of blasting works. 2) Quantity of excavation actually done as per specification and plans only is to be admitted, irrespective of total excavation of the pit.:-		
a)	SSR00009	2' x 2'6" x 5' or 0.6m x 0.75m x 1.5m (for 8m or 9.1m PSCC poles)	Pit	813.50
b)	SSR00010	2' x 2'6" x 5'6" or 0.6m x 0.75m x 1.65m (for 10m Joists/ rail poles)	Pit	893.90
c)	SSR00011	3' x 3' x 6' or 0.9m x 0.9m x 1.8m. (for 11m spun/Joist poles)	Pit	1755.20
d)	SSR00012	3' x 3' x 7' or 0.9m x 0.9m x 2.1m. (for 12.5 spun poles)	Pit	2047.80

e)	SSR00013	Rate per cft	cft	32.60
		ERECTION OF LINES		
4)		<u>PSCC/SPUN/RAIL POLES ERECTION</u> :-Erection of PSCC Poles in position aligning and setting to work as per specification including supply of labour for survey, pit- marking, T&P, transport of 1 No. PSCC Pole from road side to location including loading and unloading and back filling the earth ramming for consolidation but excluding the cost of pit excavation.		
		PSCC Poles		
a)	SSR00050	8.0 m /140 Kg PSCC Poles (Weight of pole=355 Kg)	Each	880.90
b)	SSR00051	8.0 m /200 Kg PSCC Poles (Weight of pole=380 Kg)	Each	942.90
c)	SSR00052	8.0 m /300 Kg PSCC Poles (Weight of pole=505 Kg)		
d)	SSR00053	9.1 m / 280 Kg PSCC poles (Weight of pole=680 Kg)	Each	1686.70
e)	SSR00054	11.0 m / 365 Kg PSCC poles (Weight of pole=1127 Kg)	Each	2847.00
		Spun poles		
f)	SSR00055	9.5 m Spun Pole (Weight of pole=620 Kg)	Each	2494.70
g)	SSR00056	11.0 m Spun poles (Weight of pole=900 Kg)	Each	3621.40
h)	SSR00057	12.5 m Spun Poles (Weight of pole=1,200 Kg)	Each	4828.50
		Rail Poles		
i)	SSR00058	60 Lbs / 27.3kg-. Rail poles- Length of Rail pole – 27’(8.23m) (Weight of pole=225 Kg)	Each	559.00
j)	SSR00059	75 Lbs / 34.1kg. Rail poles- Length of Rail pole – 30’(9.14m) (Weight of pole=312 Kg)	Each	774.30
k)	SSR00060	90 Lbs / 40.9kg. Rail poles- Length of Rail pole – 30’(9.14m) (Weight of pole=374 Kg)	Each	927.60
l)	SSR00061	105 Lbs / 47.7kg. Rail poles- Length of Rail pole – 30’(9.14m) (Weight of pole=436 Kg)	Each	1078.80
		RS Joist Poles		
m)	SSR00062	150x75 RS Joist Poles –Length of Joist – 9M (Weight of pole=140 Kg)	Each	345.80
n)	SSR00063	175x85 RS Joist Poles –Length of Joist – 9M (Weight of pole=215 Kg)	Each	532.90
o)	SSR00064	150x150 RS Joist Poles –Length of Joist – 9M (Weight of pole=333 Kg)	Each	823.25
5)		<u>STAY SET ERECTION</u>		

a)	SSR00080	<u>Stay erection (33 KV line or 11 KV line or LT Line)</u> <u>Data for each Stay set :-</u> Assembly and erection of Stay set made out of M.S. Rod 20 mm by burying Stay Rods with base plate in alignment with line / bisection, back billing with earth and ramming for Consolidation including fixing of guy in Stay wire of 7/12 clamps, turn buckles etc., on the Pole and binding on either side and as per specification and transporting materials and T&P from road side to work spot including loading and unloading, but excluding cost of pit excavation.	Set	261.00
b)		<u>ERECTION OF CROSS ARMS</u>		
a)	SSR00081	<u>Fixing of 1 No. 5' – 0" – Channel (100 X 50 mm) – V – X – Arms for 33 KV:-</u> Fixing of 1 No. 5' – 0" – Channel (100 X 50 mm) – V – X – Arms (for 33 KV line) to already erected 9.1 M PSCC with 1 No. Back Clamp made out of 75 X 8 mm M.S. Flat including transporting of materials and T&P from road side to location with loading and unloading	Each	107.70
b)	SSR00082	<u>Fixing of 33 KV Top fitting :-</u> Fixing of 1 No. 33 KV Top – fitting (MS Channel 100 X 50 mm) with 2 Clamps (MS flat 75 X 8 mm) to the already erected 9.1 M PSCC Pole including transporting of materials and T&P from road side to location with loading and unloading.	Each	50.00
c)	SSR00083	<u>Fixing of 11 KV 3' – 6" – V – X- Arm :-</u> Fixing of 1 No. 3' – 6" – V – X – arm made out of M.S. Channel 75 X 100 mm to the already erected 8M PSCC Pole with 1 No. Back Clamp made out of 75 X 8 mm M.S. Flat as per specification and drawing aligning them properly and setting to work including transporting of materials and T&P from road side to location with loading and unloading	Each	64.20
d)	SSR00084	<u>Fixing of 11 KV Top – Fittings :-</u> Fixing of 1 No. 11 KV Top – fittings made out of 65 X 65 X 6 mm Angle to the already erected 8M PSCC Pole with 2 Nos. B.Cs made out of 50 X 6 mm MS Flat as per specification and aligning them properly and setting to work including transporting from road side to location loading and unloading	Each	39.20
e)	SSR00085	<u>Fixing of LT 3 phase/ Single phase 'X' Arm:-</u> Fixing of 1 No. LT 3 phase/single 'X' –arms with 1 No. back clamp to the erected all types of poles as per specification and drawing aligning them properly and setting to work including transporting of materials and T&P from road side to location with loading and unloading	Each	45.70

f)	SSR00086	<u>Fixing of L.T. Top fitting :-</u> Fixing of 1 No. L.T. Top fitting made out of M.S Angle 50X50X6 mm to the already erected 8M PSCC Pole with 2 Nos. back Clamps made out of M.S. Flat as per specifications and drawing aligning them properly and setting to work including transporting of material and T&P from road side to location with loading and unloading.	Each	30.50
g)	SSR00087	Fixing of 11 KV/ LT side arm with strut	Each	107.70
h)	SSR00088	Fixing of 11 KV/ LT box type side arm with strut	Each	139.20
7)		<u>FIXING OF INSULATORS</u>		
a)	SSR00100	<u>Fixing one No. 33 KV Insulator and Pin:-</u> Fixing of 33 KV Insulator as per the specification and drawing and aligning them properly to work, transportation of 33 KV insulators and pin from road side to location including loading and unloading	Each	41.30
b)	SSR00101	<u>Fixing of 33 KV Discs with MPS (i.e., 3 Nos. Discs and 1 set MPS).</u>	1 set	140.30
c)	SSR00102	<u>33 KV Polymer disc</u>	Each	70.70
d)	SSR00103	<u>Fixing 1 No. 11 KV Disc with MPS :-</u> Fixing of 11 KV metal part along with 11 KV Disc to Cross arm as per specification and drawing aligning them properly and setting to work, transporting of materials and T&P from road side to location including loading and unloading	Each	57.60
e)	SSR00104	<u>11 KV Polymer disc</u>	Each	30.50
f)	SSR00105	<u>Fixing of one 11 KV Pin insulator & Pin :-</u>	Each	26.10
g)	SSR00106	<u>Fixing of LT Pin Insulators & GI Pins, LT shackles with MPS and CI Knobs</u>	Each	26.10
8)	SSR00107	<u>Erection of Line D.P.S</u> :-Assembly, erection, aligning line, D.P. Structure and setting to work as per drawing general specifications including transport of materials and T&P from road side to location, loading and unloading, providing of watch and ward till the line pre – handed over but excluding the cost of pit excavation :-		
9)	SSR00108	<u>STRUT - ERECTION</u>		
10)(i)		<u>Paving , Stringing & Jumpering of Conductor :-</u> Fixing of suitable rollers, bamboos, paving out Conductor on suitable supports, providing temporary stays, tensioning, sagging correctly, fixing at strain point, transporting to pin points, binding, rectification of poles, guys and jumpering as per specification and		

		drawing or various Conductors including transporting of materials and T&P from road side to location including loading and unloading and providing watch and ward till the lines are handed over(Rate per Km/Per conductor)		
a)	SSR00130	Dog conductor weighing 393Kg/Km	Per Km/C	Deleted
b)	SSR00131	100 sq.mm.AAA weighing 272.86 Kg/Km	Per Km/C	5661.50
c)	SSR00132	7/3.35 ACSR or 55 sqmm., AAA conductor weighing 149.2 Kg/Km	Per Km/C	3097.00
d)	SSR00133	7/2.59 ACSR or 34 sqmm., AAA conductor weighing 94 Kg/Km	Per Km/C	1948.80
10)(ii)		<u>Paving , Stringing & Jumpering of Cable :-</u> Fixing of suitable rollers, bamboos, paving out cable on suitable supports, providing temporary stays, tensioning, sagging correctly, fixing at strain point, transporting to pin points, binding, rectification of poles, guys and jumpering as per specification and drawing of various cables including transporting of materials and T&P from road side to location including loading and unloading and providing watch and ward till the lines are handed over(Rate per Km)		
a)	SSR00140	AB cable 1x16 + 25mm. weighing 120 Kg/Km	Per Km	2489.00
b)	SSR00141	AB cable 2x16 + 25mm weighing 189 Kg/Km	Per Km	3923.70
c)	SSR00142	AB cable 3x16+25mm weighing 258 Kg/Km	Per Km	5353.80
d)	SSR00143	185 sqmm 11 KV AB cable	Per Km	Deleted
11)		<u>CONCRETING ITEMS :-</u> Note:- 1) Pole pit Concreting is normally not allowed for PSCC/Spun poles. If concreting is to be done in certain cases, then specific approval is to be taken from the concerned SE, Operation. 2) Basic /Bed concreting is necessary for spun poles, if pole pit concreting is allowed. 3)All concreting items are to be worked out as per Govt. SSR by the respective circle office ADEs/CIVIL		
a)		<u>Concreting of pole pit</u> Concreting of pole pit of size =2'x2'6"x5' (0.6m x 0.75m 1.5 m.) with C.C.(1:4:8) using 40 mm. HBG metal including cost and Transport of all materials, labour charges, Transport of T & P and labour etc..		
i)		Labour charges in Rural areas		

ii)		Material(40mm HBG Metal + sand) up to 5Km lead		
iii)		Cement		
iv)	SSR00170	Total (Labour + Material + Cement)		
b)		<u>Concreting of stay pit</u> Concreting of stay pit of size 1' x 1'-6" x 4' (0.3mx0.45x1.2m) with C.C. (1:4:8) using 40 mm., HBG metal including cost and Transport of all materials, labour charges all leads & lifts etc.,		
i)		Labour charges in Rural areas		
ii)		Material(40mm HBG Metal + sand)		
iii)		Cement		
iv)	SSR00171	Total (Labour + Material + Cement)		
c)		<u>Construction of 1No. VCB plinth of size 5'6" x 5'x 3'6"</u> Excavation of pit of size 5'6"x5'x3', filling with sand for 6" depth, laying bed concrete with CC(1:4:8) using 40mm HBG metal for 4" depth, Construction of VCB plinth of size 5'6" x 5'x 3'6" (1.65m x 1.5m x 1.05m) with CC (1:3:6) mix using 40 mm HBG metal and providing plastering in CM (1:5) 12mm thick for top and sides above G.L. portion and white washing two coats including cost and Transport of all materials and labour charges for all operations with an average lead of 5KM and lifts etc., complete as directed by the Engineer in charge		
i)		Labour charges in Rural areas		
ii)		Material (40mm HBG Metal + sand +Janatha cem + Centering material hire charges)		
iii)		Cement		
iv)	SSR00172	Total (Labour + Material + Cement)		

		<u>Construction of 1No. Distribution transformer plinth of size 4'x4'x5'6" with brick masonry walls/RR Masonry wall:-</u>		
d)		Excavation of pit of size 4'x4'x2', filling with sand for 1' depth, laying bed concrete with CC(1:4:8) using 40mm HBG metal for 4" depth, Construction of distribution transformer plinth with 9" thick 5'10" height brick masonry wall in CM (1:6) all-round, filling the hollow portion with sand, laying of 4" thick PCC (1:3:6) using 20 mm HBG metal on top and plastering all-round the outer side of wall with CM (1:5) 12mm thick and white washing two coats, including cost and Transport of all materials and labour charges for all operation with an average lead of 5 KM and lifts etc., complete as directed by the Engineer in charge.		
i)		Labour charges in Rural areas		
ii)		Material (Bricks+ 40mm and 20mm HBG Metal + sand +Janatha cem cem + Centering material hire charges) up to 5Km lead		
iii)		Cement		
iv)	SSR00173	Total (Labour + Material + Cement)		
		<u>Construction of pillar mounted. Distribution transformer plinth using RCC:-</u>		
12)		Excavation of pit of size 5'x5'x5', filling with sand for 4"(10 cm) depth, laying bed concrete with CC(1:4:8) using 40mm HBG metal for 4" depth, Construction of distribution transformer plinth with footing size (5'x5'x4" and 3'x3'x1.5'), column size 9"x9"x8'8", beam size 9"x9"x9'3", slab size 5'x5'x4", providing reif steel 12mm rod (76 Kgs) as per the directions of ADE/Civil, re-filling the hollow portion with excavated earth, and slabs, column and beam with CM (1:5) 20mm thick, including cost and Transport of all materials and labour charges for all operation with an average lead of 5 KM and lifts etc., complete as directed by the Engineer in charge.		
i)		Labour charges in Rural areas		
ii)		Material (40mm and 20mm HBG Metal + sand + Centering material hire charges) up to 5Km lead		
iii)		Cement		
iv)		Steel		

	SSR00174	Total (Labour + Material + Cement+ steel)		
13)		<u>Construction of 1No. Distribution transformer plinth of size 4' dia and 6' height using RCC rings:-</u> Excavation of pit of size 4' dia 1'6" depth , laying one 40mm thick RCC cover on bottom/ground, laying seven RCC rings (dia 4' and 1'height each) over RCC cover, filling the hollow portion with sand, providing 4" thick RCC cover on top and pointing all the joints with CM(1:5) including cost of all materials and labour charges.		
i)		Labour charges		
ii)		Material (Sand+ RCC rings+ RCC covers)		
iii)		Cement		
iv)	SSR00175	Total (Labour + Material+ cement)		
14)	SSR00200	Erection of 33/11 KV VCB: Erection & Setting of 33/11 KV VCB with control panels on plinth carefully without causing any damages to bushings including transport, loading and unloading charges of VCB, Control cables, CTs and T&P etc labour charges complete including panel board wiring, testing and commissioning charges	Each	15719.00
15)	SSR00201	Erection of 33 KV AB Switch: Erection of 33 KV AB Switch on the booms including T&P and labour charges complete as per Dept standards	Set	1706.00
16) a)	SSR00202	a) Erection of 11 KV 400 Amps AB Switch: Erection of 11 KV 400 Amps AB Switch on the booms including T&P and labour charges complete as per Dept standards	Set	1279.00
16) b)	SSR00203	b) Erection of 11 KV AB Switch & HG Fuse set: Erection of AB Switch & HG Fuse set including transport from section office to work site, T&P labour charges complete as per department standards	Set	1608.00
17)		Wiring of 3 Phase Distribution Transformer (100/63 KVA): Wiring of 3 phase Distribution Transformer (100/63 KVA) with 95 Sqmm PVC Cable/conductor from transformer LV bushing to LT HG Fuse set and HG Fuse set to line with bear conductor supported on insulator fixed to fabricated LV frame		
a)	SSR00210	Single Feeder with PVC cable	Each	1518.00
b)	SSR00211	Double Feeder with PVC cable	Each	3037.00
c)	SSR00212	Single Feeder with open wiring	Each	1518.00

d)	SSR00213	Double Feeder with open wiring	Each	3037.00
18)	SSR00220	Erection of pole mounting structure for erection of Single Phase / Three Phase Transformers	Each	270.80
19)		Transformers Erection: Erection of Distribution Transformer on the plinth/pole carefully without causing and damaged to bushing including labour and transport complete		
a)	SSR00221	Single phase transformers 5 KVA on pole mounting structure	Each	541.60
b)	SSR00222	Single phase transformers 15 KVA on pole mounting structure	Each	813.00
c)	SSR00223	Three phase transformers 16/25KVA on pole mounting structure	Each	1083.00
d)		<u>Transformers from 50 KVA to 160 KVA</u>		
i)	SSR00224	On plinth	Each	1354.00
ii)	SSR00225	On structure		
e)		<u>Transformers from 250 KVA to 315 KVA</u>		
i)	SSR00226	On plinth	Each	1624.70
ii)	SSR00227	On structure		
f)		Erection/dismantling of healthy/sick PTR from plinth with accessories, radiators duly filling/draining out the oil and dragging the sick PTR to convenient locations for transport including stacking of radiators and accessories		
i)	SSR00228	3.15MVA	Each	6584.00
ii)	SSR00229	5 MVA	Each	8229.00
iii)	SSR00230	8 MVA	Each	9876.00
g)		Erection of additional/new PTR including loading at Stores, unloading at site & erection of PTR at site.		
i)	SSR00231	3.15MVA	Each	19751.00
ii)	SSR00232	5 MVA	Each	24688.00
iii)	SSR00233	8 MVA	Each	29626.00
h)		Replacement of sick PTR including loading of healthy PTR at Stores, unloading of healthy PTR at site, dismantling of sick PTR at site, Erection/commissioning of new PTR, loading of sick PTR at site and unloading of sick PTR at Stores etc.		
i)	SSR00234	3.15MVA	Each	39501.00
ii)	SSR00235	5 MVA	Each	49377.00
iii)	SSR00236	8 MVA	Each	59252.00

20)		<u>Erection of tilting/ horizontal type 11 KV AB Switch:-</u> Transporting of 11 KV tilting/horizontal type AB switch complete and required metallic supporting channels & studs for fixing to single pole structure so as to erect 11 KV tilting/horizontal type ABs and other parts connected to erection of the same from road side to location including loading & unloading. Erection of 11 KV tilting/horizontal type AB switch, on supporting channels, studs fitted to the pole set into operate freely i.e., opening & closing by fixing required number of guide angles, to pole and vertical operating pipe with handle including coil earthing of 11 KV tilting/horizontal type ABS handle as per standards. All the materials supplied by Department		
a)	SSR00250	Erection of tilting type 11 KV AB Switch to Single pole DP Structure:-	Each	1016.00
b)	SSR00251	Erection of horizontal type 11 KV AB Switch on DP Structure:-	Each	1136.00
21)		<u>Erection of Earth Electrodes:</u>		
		Erection of earth electrodes using CI/GI pipes including pit excavation, and cement collar of 2' dia x 1' height etc complete.		
21) a)	SSR00252	a)GI Pipes	Each	610.00
21) b)	SSR00253	b)CI Pipes	Each	746.00
		Note:- In case GI/C.I Pipes are procured by the Contractor then 12% over SPDCL stores rate can be allowed for pipe cost .		
22)	SSR00254	<u>Erection of 33 KV HG Fuse set at Single Pole DTR Structure:-</u> Transporting of 33 KV H.G. Fuse set materials like post type insulators, Horns, pedestals etc., with seating Angles/Channels, made out of M.S. Angle from road side to location including loading & unloading and erection of 33 KV HG fuse set at required height as per standards with connected angles & Channels by adjusting the Horns to the required gap at single pole DTR structure. All the materials supplied by Departments.	Set	650.00
23)	SSR00255	<u>Erection of 11 KV HG Fuse set at Single Pole DTR Structure:-</u> Transporting of 11 KV H.G. Fuse set with seating Angles/Channels, side arms, made out of M.S. Angle with MS. Angle stud from road side to location including loading & unloading and erection of 11 KV HG fuse set at required height as per standards with connected angles & Channels by adjusting the Horns to the required gap at single pole DTR structure. All the materials supplied by Departments.	Set	270.80

24)	SSR00256	Erection of LT Fuse set at Single Pole DTR Structure:- Transporting of LT Fuse set with seating Angles/Channels, side arms, made out of M.S. Angle with MS. Angle stud from road side to location including loading & unloading and erection of LT fuse set at required height as per standards with connected angles & Channels by adjusting the Horns to the required gap at single pole DTR structure. All the materials supplied by Departments.	Set	202.00
25)	SSR00257	Earthing of Distribution Transformers: Running of No 8 G.I wire from Distribution Transformer (3 Phase) AB Switch, HG Fuse Set V'X' Arm etc running of 14 SWG G.I. Wire including double earthing as per specification for running of total 10 Nos GI wires. Note:- In case GI wire is procured by the Contractor then 12% over SPDCL stores rate can be allowed for GI wire cost.	Per Lead Per length	20.70
26)		Paving out and laying of 33KV/11 KV UG cable duly forming the cable trench including excavation of trench 2'X2' filling the trench with excavated earth including transporting of cable etc. complete with out construction of trench.		
a)	SSR00270	33 KV UG cable	RM	299.00
b)	SSR00271	11 KV UG cable	RM	162.00
27)	SSR00272	Labour charges for erection of 11 KV cable heat shrunken joint	Each	4064.00
28)	SSR00273	Labour charges for erection of 33 KV cable heat shrunken joint	Each	5417.00
29)	SSR00274	11 KV AB cable end termination consisting of 3 phases.	Set	6772.00
30)		Labour charges for erection of 33 or 11 KV C.Ts including all connections.		
a)	SSR00275	33 KV CTs	Each	434.00
b)	SSR00276	11 KV CTs	Each	299.00
31)	SSR00277	Labour charges for erection of HT metering cubicle including all connections and earthing as per departmental standards.	Each	678.60
32)	SSR00278	Labour charges for erection of HT Trivector meter box including all connections and earthing as per departmental standards.	Each	434.00
33)	SSR00279	Dismantling and Re-erection of Single Phase/ Three Phase services (Any where in the district same rate only. NO EXTRA RATE TOWARDS AREA ALLOWANCES IS ALLOWED)	One Service	24.00

34)		Extra percentage towards work involving (a) Single Pole (b) Two Pole (c) Three Poles (This rate is applicable to both Urban and Rural areas)		
a)		Single Pole		100% Extra
b)		Two Poles		50% Extra
c)		Three Poles		20% Extra
35) a)		(a) Labour charges for rectification of all types of leaned poles where the lean is more than 30 degree to the vertical.	35% of Erection Charges	
35) b)		(b) Charges for restringing of loose spans	50% of stringing charges	
36)	SSR00300	Labour charges for fixing of tube light fitting for street light	Each	136.00
37)	SSR00301	Labour charges for fixing of MV/SV lamp fitting for street light	Each	150.00
38)		Laying of earth mat/risers including excavation of trenches, welding, fixing lugs, connecting to equipment and refilling trenches using MS flat 75x8mm or 50x8mm.		
a)	SSR00302	75x8mm	RM	63.00
b)	SSR00303	50x8mm	RM	42.00
39)		<p>Providing security fencing of size 2.4m x 3m x3m (total area 28.8 sqm) to Distribution Transformer structures with gate and locking arrangement which is one side removable and three sides fixed fencing as per the dimensions mentioned in the drawing using G.I. Chain link mesh 8 guage 50.8mm x 50.8mm (2" x 2") size, MS angle 50 x 50 x 6, MS flat 35 x 6, MS flat 25 x 6, bolts, nuts, Aldrop, hinges, concreting the supports with PCC (1:4:8), painting one coat red oxide, two coats synthetic enamel paint, complete for finished item of work.</p> <p>Note:- Works are to be executed on seeking estimate sanction from the corporate office.</p> <p>Whenever it is not possible to provide fencing of size 2.4mx3mx3m, then size may be reduced and payment may be arranged based on the actual area.</p>		
a)	SSR00304	Rural areas	Sqm	1021.00

b)	SSR00305	All other areas	Sqm	1045.00
		<u>Painting of Old or new structures/ equipment in 33/11 KV SS</u>		
40)		Painting of old/new structures with one coat of aluminium paint including cost and conveyance of paints, brushes, labour complete.		
a)	SSR00320	Cost of paint	Sqm	30.00
b)	SSR00321	Labour charges	Sqm	42.00
c)	SSR00322	Total (Cost of paint + labour charges)	Sqm	73.00
d)	SSR00323	Cost of paint	MT	1675.00
e)	SSR00324	Labour charges	MT	2333.00
f)	SSR00325	Total (Cost of paint + labour charges)	MT	4007.00
41)		Painting of old/new equipment including transformers, VCBs, breakers with one coat of synthetic enamel paint including cost and conveyance of paints, brushes, labour complete.		
a)	SSR00326	Cost of paint	Sqm	23.90
b)	SSR00327	Labour charges	Sqm	42.40
c)	SSR00328	Total (Cost of paint + labour charges)	Sqm	66.00
d)	SSR00329	Cost of paint	MT	1316.00
e)	SSR00330	Labour charges	MT	2333.00
f)	SSR00331	Total (Cost of paint + labour charges)	MT	3649.00
42)		Painting of old/new structures with one coat of Anti corrosive bitumen black paint including cost and conveyance of paints, brushes, labour complete.		
a)	SSR00332	Cost of paint	Sqm	44.60
b)	SSR00333	Labour charges	Sqm	42.40
c)	SSR00334	Total (Cost of paint + labour charges)	Sqm	87.00
d)	SSR00335	Cost of paint	MT	2452.00
e)	SSR00336	Labour charges	MT	2333.00
f)	SSR00337	Total (Cost of paint + labour charges)	MT	4785.00

43)		Painting of new structures/ equipment in 33/11 KV SS with one coat of Red oxide paint and two coats of aluminum paint.		
a)	SSR00338	Cost of paint	Sqm	93.30
b)	SSR00339	Labour charges	Sqm	75.00
c)	SSR00340	Total (Cost of paint + labour charges)	Sqm	168.80
d)	SSR00341	Cost of paint	MT	5144.00
e)	SSR00342	Labour charges	MT	4127.00
f)	SSR00343	Total (Cost of paint + labour charges)	MT	9271.00
44)		Painting of new structures/ equipment in 33/11 KV SS with one coat of Red oxide paint and two coats of synthetic enamel paint.		
a)	SSR00344	Cost of paint	Sqm	75.00
b)	SSR00345	Labour charges	Sqm	75.00
c)	SSR00346	Total (Cost of paint + labour charges)	Sqm	150.00
d)	SSR00347	Cost of paint	MT	4127.00
e)	SSR00348	Labour charges	MT	4127.00
f)	SSR00349	Total (Cost of paint + labour charges)	MT	8254.00
		DISMANTLING		
45)		For all dismantling works 50% of erection charges shall be adopted. For poles dismantling charges at 50% is allowed only, if they are retrieved in good condition.		
		MRT WORKS		
46)	SSR00400	Labour for opening of the top cover of CSP Transformer by cutting with grinder and welding/fixing with bolts and nuts of the top cover for various capacities of Distribution transformers ie.,63 KVA,100KVA 250 KVA and 500 KVA at SPM shed inclusive of cost of welding electrodes, cost of bolts and nuts and drilling of holes	Each	1705.00
47)	SSR00401	Labour charges for reclamation of used transformer oil at MRT shed	Kilo litre	4875.00
48)	SSR00402	Providing of MS vent pipe with diaphragm to the top cover of the D.Tr. The vent Pipe consists of 50mm dia, 4mm thick copper foil should be fixed between flange of the Nipple and 180 bend. Wire gauge protection should be provided at the end of the bend Duly providing flange.	Each	1030.00
		Note:- For the above three items of work the required machinery and material except general consumables		

		such as cotton waste etc., shall be supplied by the Dept at free of cost		
49)		Handling, testing, providing of seals with cover, stacking neatly.		
a)	SSR00403	S phase energy meter.	Each	10.90
b)	SSR00404	Testing of 3 Phase energy meter	Each	18.50
50)		Removing the meter back cover, cleaning the old meter cover, painting the meter top & bottom covers with good approved enamel black paint, cleaning the meter with petrol and oiling to bearings with good 2 in 1 oil (Usha make) refixing the meter in meter cover duly providing new gaskets. Testing and adjustments of the meter as per departmental standards, loading, transporting, and unloading including introducing sealing wire to each meter including replacement of glass wherever necessary.		
a)	SSR00405	Including cost of paint	Each	28.30
b)	SSR00406	Excluding cost of paint	Each	20.70
51)	SSR00407	Removal or fixing of PC coil, CC coil or Disc, cyclometer or terminal block.	Each	3.30
52)		Labour charges for sealing of single phase/3 phase meters including transportation of meter box carton to work spot, unpacking, packing of sealed meters and stocking etc., complete.		
a)	SSR00408	2 Seals	Each	6.00
b)	SSR00409	3 Seals	Each	6.50
c)	SSR00410	4 Seals	Each	9.80
53)		Labour charges for sealing of S Phase/ 3 phase energy meters housed in PP box including transportation unpacking and packing and stocking of meter box etc., complete.		
a)	SSR00411	2 Seals	Each	6.50
b)	SSR00412	3 Seals	Each	12.00
c)	SSR00413	4 Seals	Each	15.20
d)	SSR00414	6 Seals	Each	23.90
54)		<u>Metering arrangement with CTs to 16/25 KVA Agricultural DTRs</u>		

a)	SSR00415	Supply and rigging of meter with country wood of size 1'x1/2', 7/20 finolex wire, bolts and nuts and screws along with lugs. Removing of metallic strip in syntex box, fixing of wooden board suitably, fixing of meter and CT in position including fixing of neutral terminal bolt. Providing of internal wiring duly giving proper connections, opening of internal link in the meter duly providing sealing after testing. (energy meter and box will be supplied by the dept)	Each	703.60
b)	SSR00416	Supply and fixing of 2meters of aluminium cable, 05m of 3/20 copper wire, 2 sets of clamps with bolts and nuts and misc items like insulation tapes, screws etc., including labour charges for fixing of box and transport charges including loading and unloading.	Each	324.00
	SSR00417	.do. with 4 sets of clamps	Each	379.50
		<u>FABRICATION OF LINE MATERIALS:-</u>		
		Important Note:. (1)All the fabrication works should be done by using department materials within stores yard/premises only. Department Materials shall not be issued to the out side the stores, for fabrication purpose. Divisional Engineer/ Tech shall monitor the issue of fabrication material.		
		<u>(2) No extra rate towards area allowance is allowed in respect of fabrication of line materials</u>		
		<u>(3)Fabrication rates are inclusive of cost of Power, welding rods, Oxygen and Acetylene for cutting, welding and cutting charges, bending charges, drilling charges, red oxide paint. In case any of the above mentioned items are done in our dept workshop with the help of machinery, material and staff then accordingly rate is to be reduced from these approved rates.</u>		
55)		CUTTING CHARGES:-		
a)	SSR00500	60 lbs. Rail poles	Each	34.80
b)	SSR00501	90 lbs. Rail poles	Each	54.40
c)	SSR00502	105 lbs. Rail poles	Each	54.40
d)	SSR00503	R.S. Joists of various sizes	Each	27.20
e)	SSR00504	M.S. Channels of size 75 x 40 mm. and 80 x 40 mm	Each	8.70
f)	SSR00505	M.S. Channels of size 100 x 50 mm. and 125 x 65 mm	Each	9.80

g)	SSR00506	M.S. Channels of size 150 x 75 mm. and above	Each	14.10
h)	SSR00507	M.S. Angles of sizes 50 x 50 x 6 mm. and 55 x 55 x 5 mm.	Each	4.40
i)	SSR00508	M.S. Angles of size 65 x 65 x 6 mm. and above	Each	5.40
j)	SSR00509	M.S. Flat 75 x 8 mm.	Each	3.30
k)	SSR00510	M.S. Flat of size 50 x 6 mm.	Each	3.30
l)	SSR00511	M.S. Flat of width below 50 mm.	Each	2.20
m)	SSR00512	M.S. Rounds up to 23 mm.	Each	3.30
56)		<u>DRILLING CHARGES</u>		
a)		Charges for drilling of holes to various sizes of angle, channel and flats.		
i)	SSR00530	For holes up to 18 mm.	Each	3.30
ii)	SSR00531	For holes above 18 mm	Each	4.40
b)		Drilling of holes of various sizes to R.S. Joists and Rail poles with ratchet or hand Drilling machine:		
i)	SSR00532	For R.S. Joists	Each	5.40
ii)	SSR00533	For 60 lbs. Rail poles	Each	6.00
iii)	SSR00534	For 90 lbs. Rail poles	Each	7.10
c)		Drilling of holes of various sizes to R.S. Joists or Rails poles using power drilling Machine:.		
i)	SSR00535	For R.S. Joists	Each	4.40
ii)	SSR00536	For 60 lbs. Rail poles	Each	5.40
iii)	SSR00537	For 90 lbs. And 120 lbs Rail	Each	6.50
57)		<u>FABRICATION CHARGES: Fabrication of the following materials including cost of consumables, cutting, drilling charges, but excluding the cost of raw materials</u>		
a)	SSR00550	33 KV "V" Cross arms with 100x50 mm MS Channel 2.08mtrs(6'.10") – Weight of the materials=19.0 Kg	Each	530.70

b)		11KV “V” Cross arms .		
i)	SSR00551	With 75x40 mm M.S. Channel . Weight of the materials = 9 Kgs.(with 4 nos 50x50x6 packing plates are welded)	Each	480.70
ii)	SSR00552	With 65x65x6mm M.S. Angle – . Weight of the materials =8.2 Kgs	Each	273.00
c)		LT 3.Phase 4 Wire Cross arms.		
i)	SSR00553	With 50x50x6mm M.S. Angle(3’.8”) . Weight of the materials = 5.75 Kgs.	Each	138.00
ii)	SSR00554	With 65x65x6mm M.S. Angle (3’.8”) – Weight of the materials = 7 Kgs	Each	142.50
d)		LT 3.Phase 5 Wire Cross arms .		
i)	SSR00555	With 50x50x6mm M.S. Angle(4’.5”)– Weight of the materials = 7.3 Kgs	Each	168.60
ii)	SSR00556	With 65x65x6mm M.S. Angle (4’.5”) – Weight of the materials = 9.6 Kgs	Each	171.80
e)	SSR00557	LT S.Phase 3 Wire Cross arms with 50x50x6mm M.S. Angle (2’.5”) = Weight of the materials = 4.2 Kgs.	Each	108.75
f)		M.S. Stay sets		
i)	SSR00558	M.S. Stay sets with 20 mm M.S. Rod & Stay Clamps with 100x50mm M.S. Channel . Weight of the materials = 10.3 Kgs	Each	147.80
ii)	SSR00559	M.S. Stay sets with 20 mm M.S. Rod & Stay Clamps with 75 x40mm M.S. Channel . Weight of the materials = 10.2 Kgs.	Each	138.00
iii)	SSR00560	M.S. Stay sets with 16mm M.S. Rod & Stay Clamps with 100x50mm M.S. Channel . Weight of the materials = 8.0 Kgs	Each	140.30
iv)	SSR00561	M.S. Stay sets with 16mm M.S. Rod & Stay Clamps with 75x40xmm M.S. Channel . Weight of the materials = 7.6 Kgs	Each	132.70
v)	SSR00562	M.S. Stay sets with 16mm M.S. Rod & Stay Clamps with 50x50x6mm M.S. Angle – Weight of the materials = 6.3 Kgs	Each	127.00
g)		33KV Top Fitting		
i)	SSR00563	33KV Top Fitting with Clamps with 75x40mm M.S. Channel . Weight of the materials = 6.9 Kgs.	Each	148.00
ii)	SSR00564	33KV Top Fitting with Clamps with 65x65x6mm M.S. angle . Weight of the materials = 6.5 Kgs.	Each	132.70
h)		11KV Top Fittings		

i)	SSR00565	11KV Top Fittings with Clamps 65x65x6mm M.S. Angle – Weight of the materials = 4.4 Kgs.	Each	132.70
ii)	SSR00566	11KV Top Fittings with Clamps 50x50x6mm M.S. Angle . Weight of the materials = 3.63Kgs.	Each	127.20
iii)	SSR00567	11KV Special Top Fittings with Clamps (2'.0" Height) 50x50x6mm M.S. Angle – Weight of the materials = 3.6Kgs.	Each	127.20
i)	SSR00568	LT Top Fittings with Clamps 50x6mm M.S. Flat – Weight of the materials = 2.4 Kgs.	Each	41.30
j)	SSR00569	11KV Tapping Cross arms with (5.6") 100x50mm M.S. Channel – Weight of the materials =13.4 Kgs	Each	82.70
k)	SSR00570	11KV Tapping Cross arms with (5.6") 75x40mm M.S. Channel – Weight of the materials = 11.2 Kgs.	Each	130.50
l)	SSR00571	33KV Tapping Cross arms with (7'.0") 100x50mm M.S. Channel – Weight of the materials = 16.2 Kgs.	Each	88.00
m)	SSR00572	HT/LT Side arms with strut (7'.6") 75x40mm M.S. Channel (3'.6") 50x50x6mm M.S. Angle (7'.6") 50x50x6mm M.S. Angle (3'.0") 50x50x6mm M.S. Angle – Weight of the materials = 37.600Kgs.	Each	121.80
n)	SSR00573	LT Side arms with strut (5'.6") 50x50x6mm M.S. Angle (6'.0") 50x50x6mm M.S. Angle – Weight of the materials = 15.600Kgs.	Each	177.00
o)		M.S Back Clamps (1'.3")		
i)	SSR00574	With 50x6mm M.S. Flat for 8m/140 Kg Pole – Weight of the materials = 0.84 Kgs.	Each	17.40
ii)	SSR00575	With 50x6mm M.S. Flat for 8m/200 Kg Pole – Weight of the materials = 0.924 Kgs.	Each	17.40
iii)	SSR00576	With 75x8mm M.S. Flat for 9.1m/280 Kg Pole – Weight of the materials = 2.17 Kgs.	Each	18.50
p)		M.S. Stay Clamps (1'.1" X 2Nos.) 50x6mm M.S. Flat – Weight of the materials = 1.640Kgs.		
i)	SSR00577	For 8m/140 Kg Pole – Weight of the materials = 1.38 Kgs.	Each	28.30
ii)	SSR00578	For 8m/200 Kg Pole – Weight of the materials = 1.416 Kgs.	Each	29.40
iii)	SSR00579	For 9.1m/280 Kg Pole – Weight of the materials = 3.71 Kgs.	Each	35.90
q)	SSR00580	Pole mounting arrangement for 3.Phase 16/25 KVA DTR'S (4'.0=2Nos.) 75x40mm M.S. Channel	Each	267.50

		(5'.0" =1No) 50x50x6mm M.S. Angle (1'.6"=2Nos.)50x50x6mm M.S. Angle (1'.1"=2Nos.)50x50x6mm M.S. Flat – Weight of the materials = 26Kgs		
r)	SSR00581	D.P. Structures total set	Each set	554.60
		10' – 2Nos. 100 x 50 MS Channel 10' .2Nos. 50 x 50x 6 Angle 3' – 3 Nos. 75 x 40 Channel 2' – 4Nos. 50 x 6 MS Flat		
s)		Spun Pole Clamps		
	SSR00582	i) Back Clamps	Each	31.50
	SSR00583	ii) Stay Clamps	Each	26.10
t)	SSR00584	Extension Pieces	Each	161.00
v)	SSR00585	HT/LT Spun Pole mounting 8' – 100 x 50 Channel 21' – 65 x 65 Angle 12' – 75 x 8 MS Flat	Set	375.00
w)	SSR00586	AB Switch OFF & ON Base with Clamp	Set	64.00
58)		<u>WELDING CHARGES:.</u>		
59)		ARC WELDING charges for all steel materials to a length of 25 mm.(1") of weld including cost of power and electrodes.		
a)	SSR00587	Double welding	25mm	14.10
b)	SSR00588	Single welding	25mm	6.50
60)	SSR00589	GAS WELDING charges for all steel materials to a length of 25 mm.(1") of weld including cost of gas	25mm	12.00
61)	SSR00590	GAS CUTTING	25mm	4.90
62)	SSR00591	Structural Steel erection Charges	1Kg	18.50

IV. LOADING AND UN.LOADING CHARGES
(No extra rate towards area allowance is allowed in respect of loading and unloading charges)

S.No.	Item	Unit	Loading		Un-loading	
			SAP Service code	Rate	SAP Service code	Rate
1)	<u>POLES/ SUPPORTS</u>					
a)	PSCC POLES					
i)	8m /140 Kg. PscC Poles	EA	SLD0000 1	83.50	SUD00001	28.00
ii)	8m /200 Kg. PscC Poles	EA	SLD0000 2	83.50	SUD00002	28.00
iii)	8m /300 Kg. PscC Poles	EA	SLD0000 3	124.75	SUD00003	41.00
iv)	9.1m /280 Kg. PscC Poles	EA	SLD0000 4	140.00	SUD00004	41.00
b)	SPUN POLES					
	11m /350 Kg. Spun Poles	EA	SLD0000 5	304.80	SUD00005	98.70
	12.5m /350 Kg. Spun Poles	EA	SLD0000 6	360.00	SUD00006	111.70
c)	RS JOISTS /RAIL POLES					
i)	RS Joists 150x150/175x80(10m)	EA	SLD0000 7	83.50	SUD00007	28.00
ii)	Rail poles 60 lbs (27 feet)	EA	SLD0000 8	55.30	SUD00008	17.40
iii)	Rail poles 90 lbs. (30 feet)	EA	SLD0000 9	90.00	SUD00009	28.00
d)	RCC Base Plates	EA	SLD0001 0	3.30	SUD00010	3.30
2)	<u>TRANSFORMERS</u>					
a)	Power Transformers					
i)	1.6 MVA PTR	EA	SLD0001 1	1970.0 0	SUD00011	1970.0 0
ii)	3.15 MVA PTR	EA	SLD0001 2	6423.0 0	SUD00012	6423.0 0
iii)	5.0 MVA PTR	EA	SLD0001 3	8029.0 0	SUD00013	8029.0 0
iv)	8.0 MVA PTR	EA	SLD0001 4	9634.0 0	SUD00014	9634.0 0
b)	Distribution Transformers					

i)	1Ph 5KVA DTR	EA	SLD00015	69.40	SUD00015	69.40
ii)	1Ph 15KVA/3Ph 16/25 KVA DTR	EA	SLD00016	153.00	SUD00016	153.00
iii)	DTR's upto 100 KVA	EA	SLD00017	278.00	SUD00017	278.00
iv)	Amorphous make DTRs 100 KVA	EA	SLD00018	347.00	SUD00018	347.00
v)	160KVA DTR	EA	SLD00019	417.60	SUD00019	417.60
vi)	DTRs from 250 KVA to 315 KVA	EA	SLD00020	695.00	SUD00020	695.00
vii)	33 KV P.T. (or) C.T.	EA	SLD00021	153.00	SUD00021	153.00
viii)	11 KV P.T. (or) C.T.	EA	SLD00022	77.00	SUD00022	77.00
c)	Isolators					
i)	33 KV AB switch	EA	SLD00023	65.00	SUD00023	65.00
ii)	11 KV AB switch	EA	SLD00024	33.60	SUD00024	33.60
iii)	11 KV H.G. Fuse set	EA	SLD00025	8.70	SUD00025	8.70
iv)	L.T. H.G. Fuse set	EA	SLD00026	7.00	SUD00026	7.00
3)	<u>EQUIPMENT</u>					
a)	33 KV VCB	SET	SLD00027	1110.00	SUD00027	1110.00
b)	11 KV VCB	SET	SLD00028	915.00	SUD00028	915.00
c)	11 KV control panels	EA	SLD00029	125.00	SUD00029	125.00
d)	11 KV Metering cubicle	SET	SLD00030	166.00	SUD00030	166.00
e)	Batteries	EA	SLD00031	3.30	SUD00031	3.30
f)	Trickal Chargers with batteries	EA	SLD00032	28.00	SUD00032	28.00
4)	<u>IRON MATERIALS</u>					
a)	Iron and steel materials	TO	SLD00033	249.00	SUD00033	249.00
b)	H.T, Mild steel wire	TO	SLD00034	249.00	SUD00034	249.00
c)	Stay wire, G.I wire	TO	SLD00035	249.00	SUD00035	249.00
d)	D.P. structural materials	SET	SLD00036	28.00	SUD00036	28.00
e)	33 KV ' V' cross arms	EA	SLD00037	5.10	SUD00037	5.10
f)	11 KV ' V' cross arms	EA	SLD00038	4.90	SUD00038	4.90
g)	Three phase cross arms	EA	SLD00039	1.70	SUD00039	1.70
h)	Single phase cross.arms	EA	SLD00040	1.20	SUD00040	1.20
i)	33 KV Top Fittings	EA	SLD00041	2.80	SUD00041	2.80
j)	11 KV Top Fittings	EA	SLD00042	2.30	SUD00042	2.30

k)	L.T Top Fittings	EA	SLD0004 3	1.20	SUD00043	1.20
l)	Back clamps	EA	SLD0004 4	1.20	SUD00044	1.20
m)	Stay clamps set	SET	SLD0004 5	1.20	SUD00045	1.20
n)	Stay set	SET	SLD0004 6	4.60	SUD00046	4.60
o)	G.I. Earth pipes	EA	SLD0004 7	2.20	SUD00047	2.30
p)	C.I. Earth pipes	EA	SLD0004 8	8.70	SUD00048	8.70
q)	'A' Type Distribution Box	EA	SLD0004 9	6.80	SUD00049	6.80
r)	'B' type distribution box	SET	SLD0005 0	2.80	SUD00050	2.80
5)	M.S/GI Bolts & Nuts	KG	SLD0005 1	0.65	SUD00051	0.65
6)	<u>INSULATORS & PINS</u>					
a)	33KV					
i)	33 KV Post type Insulators					
(1)	2 piece type	EA	SLD0005 2	1.20	SUD00052	1.20
(2)	Single piece solid core type	EA	SLD0005 3	1.80	SUD00053	1.80
ii)	33 KV Pin Insulators	EA	SLD0005 4	1.60	SUD00054	1.60
iii)	33 KV G.I. Pins	EA	SLD0005 5	0.75	SUD00055	0.75
iv)	33 KV Polymer disc	EA	SLD0005 6	0.75	SUD00056	0.75
v)	33 KV LAS	EA	SLD0005 7	27.10	SUD00057	27.10
b)	11KV					
i)	11 KV Post type Insulators	EA	SLD0005 8	1.20	SUD00058	1.20
ii)	11 KV Pin Insulators	EA	SLD0005 9	1.20	SUD00059	1.20
iii)	11 KV GI Pins	EA	SLD0006 0	0.85	SUD00060	0.85
iv)	11 KV Disc Insulators	EA	SLD0006 1	1.20	SUD00061	1.20
v)	11 KV Polymer disc	EA	SLD0006 2	0.80	SUD00062	0.80
vi)	11 KV/33KV Metal parts	SET	SLD0006 3	0.80	SUD00063	0.80
vii)	H.T. Guy Insulators	EA	SLD0006 4	0.90	SUD00064	0.90
viii)	11 KV LAS					
(1)	11 KV LAS(Station Type)	EA	SLD0006 5	14.10	SUD00065	14.10
(2)	11 KV LAS(Line Type)	EA	SLD0006 6	2.80	SUD00066	2.80
c)	LT					

i)	L.T. Pin Insulators	EA	SLD00067	0.70	SUD00067	0.70
ii)	L.T.G.I. Pins	SET	SLD00068	0.70	SUD00068	0.70
iii)	L.T. Shackles	EA	SLD00069	0.80	SUD00069	0.80
iv)	L.T. metal parts	SET	SLD00070	0.70	SUD00070	0.70
v)	L.T. Guy Insulators	EA	SLD00071	0.80	SUD00071	0.80
7)	<u>CONDUCTOR/ CABLE</u>					
a)	Conductor Drum(All)	EA	SLD00072	278.00	SUD00072	278.00
b)	PVC Cable(>25 upto 185sq.mm)	TO	SLD00073	249.00	SUD00073	249.00
c)	PVC Cable upto and 10 Sq. mm	RO L	SLD00074	1.80	SUD00074	1.80
d)	Un coiling of cables/ conductors					
i)	Un-coiling conductor from MainDrum & Ldg	KM			SWR20072	69.00
ii)	Un-coiling PVC / Ctrlcable 25 to 185 Sqmm-100RM	EA			SWR20073	55.00
iii)	Un-coiling XLPE Power Cable	M			SWR20074	10.00
iv)	Un-coiling of panther conductor-100RM	EA			SWR20075	74.00
8)	<u>GENERAL ITEMS</u>					
a)	Transformer oil drums with oil	EA	SLD00075	41.20	SUD00075	41.20
b)	Empty oil drums	EA	SLD00076	2.80	SUD00076	2.80
c)	C.T. Meters	EA	SLD00077	8.60	SUD00077	8.60
d)	3Ph/CT Meter Boxes	EA	SLD00078	2.80	SUD00078	2.80
e)	3Ph Meters	EA	SLD00079	2.30	SUD00079	2.30
f)	1Ph Meters	EA	SLD00080	1.40	SUD00080	1.40
g)	Pilfer proof box	SET	SLD00081	1.10	SUD00081	1.10
h)	Fuse units 16 A to 32 A	EA	SLD00082	0.70	SUD00082	0.70
i)	Fuse units 63 A / 100 A	EA	SLD00083	0.60	SUD00083	0.60
j)	Fuse units 200 A, 300 A	EA	SLD00084	0.80	SUD00084	0.80
k)	Lugs	CA R	SLD00085	0.90	SUD00085	0.90
l)	Male / Female Contacts	BA G	SLD00086	14.10	SUD00086	14.10
m)	Cable Jointing kits	EA	SLD00087	1.50	SUD00087	1.50
n)	Street light fixture	SET	SLD00088	1.00	SUD00088	1.00

o)	Fuse wire/MRT Materials	KG	SLD00089	1.40	SUD00089	1.40
p)	Winding wire up to 5 Kg	RO L	SLD00090	3.70	SUD00090	3.70
q)	Winding wire more than 5 Kg	RO L	SLD00091	8.60	SUD00091	8.60
r)	Paints					
i)	Paints upto & including 5 Lts	EA	SLD00092	1.50	SUD00092	1.50
ii)	Paints >5 Lts<=20 lts	EA	SLD00093	5.80	SUD00093	5.80
s)	Cement	TO	SLD00094	111.70	SUD00094	111.70
t)	Loading and unloading of any other materials					
i)	Indoor Items upto 10 Kgs	BA G	SLD00095	8.60	SUD00095	8.60
ii)	Indoor Items > 10 Kgs	BA G	SLD00096	14.10	SUD00096	14.10
iii)	11KV200A TT Type ABSwitch M.A	EA	SLD00097	9.10	SUD00097	9.10
iv)	40 KVA DTR mounting arrangements	EA	SLD00098	18.90	SUD00098	18.90
v)	33KV HV/LV twin feeder panel	EA	SLD00099	131.00	SUD00099	131.00
9)	<u>SCRAP</u>					
a)	Al./Cu/Plastic Scrap	TO	SLD00100	554.00	SUD00100	554.00
b)	Meters Scrap W/weight	TO	SLD00101	554.00	SUD00101	554.00
c)	MS/Lead Scrap W/weight	TO	SLD00102	417.60	SUD00102	417.60
10)	Seating arrangements of 3ph 16/25KVA DTRs	EA	SWR20033	13.70	SWR20134	13.70

TRANSPORT CHARGES

1. Transport of Cement:-

SI No	Lead in KM	Transport charges of Cement per MT
1	Up to and including 5.0Km	Rs.222.00Ps
2	5.0Km to 500 Km	Rs.222.00Ps +Rs.5.70 Ps per Km above5.0Km
3	Beyond 500 Km	Rs.3.70 Ps per Km above

2. Transport of steel materials(including ribbed rod, HT steel wire, channels, angles, RS joists, rail poles, fabricated materials) and lubricating oil:-

(These rates are excluding the loading, un-loading & stacking charges).

SAP Service code	Lead in KM	Rate/MT	SAP Service code	Lead in KM	Rate/MT	SAP Service code	Lead in KM	Rate/MT	SAP Service code	Lead in KM	Rate/MT
STRS0001	1.0 KM	258.00	STRS0176	176.0 KM	1697.00	STRS0351	351.0 KM	2932.00	STRS0526	526.0 KM	4167.00
STRS0002	2.0 KM	267.00	STRS0177	177.0 KM	1704.00	STRS0352	352.0 KM	2939.00	STRS0527	527.0 KM	4174.00
STRS0003	3.0 KM	279.00	STRS0178	178.0 KM	1711.00	STRS0353	353.0 KM	2946.00	STRS0528	528.0 KM	4181.00
STRS0004	4.0 KM	290.00	STRS0179	179.0 KM	1718.00	STRS0354	354.0 KM	2953.00	STRS0529	529.0 KM	4188.00
STRS0005	5.0 KM	299.00	STRS0180	180.0 KM	1726.00	STRS0355	355.0 KM	2960.00	STRS0530	530.0 KM	4195.00
STRS0006	6.0 KM	325.00	STRS0181	181.0 KM	1733.00	STRS0356	356.0 KM	2967.00	STRS0531	531.0 KM	4202.00
STRS0007	7.0 KM	334.00	STRS0182	182.0 KM	1740.00	STRS0357	357.0 KM	2974.00	STRS0532	532.0 KM	4209.00
STRS0008	8.0 KM	346.00	STRS0183	183.0 KM	1747.00	STRS0358	358.0 KM	2982.00	STRS0533	533.0 KM	4216.00
STRS0009	9.0 KM	356.00	STRS0184	184.0 KM	1754.00	STRS0359	359.0 KM	2989.00	STRS0534	534.0 KM	4223.00
STRS0010	10.0 KM	368.00	STRS0185	185.0 KM	1761.00	STRS0360	360.0 KM	2996.00	STRS0535	535.0 KM	4230.00
STRS0011	11.0 KM	380.00	STRS0186	186.0 KM	1768.00	STRS0361	361.0 KM	3003.00	STRS0536	536.0 KM	4237.00
STRS0012	12.0 KM	389.00	STRS0187	187.0 KM	1775.00	STRS0362	362.0 KM	3010.00	STRS0537	537.0 KM	4245.00
STRS0013	13.0 KM	401.00	STRS0188	188.0 KM	1782.00	STRS0363	363.0 KM	3017.00	STRS0538	538.0 KM	4252.00
STRS0014	14.0 KM	411.00	STRS0189	189.0 KM	1789.00	STRS0364	364.0 KM	3024.00	STRS0539	539.0 KM	4259.00
STRS0015	15.0 KM	422.00	STRS0190	190.0 KM	1796.00	STRS0365	365.0 KM	3031.00	STRS0540	540.0 KM	4266.00
STRS0016	16.0 KM	431.00	STRS0191	191.0 KM	1803.00	STRS0366	366.0 KM	3038.00	STRS0541	541.0 KM	4273.00
STRS0017	17.0 KM	440.00	STRS0192	192.0 KM	1810.00	STRS0367	367.0 KM	3045.00	STRS0542	542.0 KM	4280.00
STRS0018	18.0 KM	452.00	STRS0193	193.0 KM	1817.00	STRS0368	368.0 KM	3052.00	STRS0543	543.0 KM	4287.00
STRS0019	19.0 KM	463.00	STRS0194	194.0 KM	1824.00	STRS0369	369.0 KM	3059.00	STRS0544	544.0 KM	4294.00
STRS0020	20.0 KM	477.00	STRS0195	195.0 KM	1831.00	STRS0370	370.0 KM	3066.00	STRS0545	545.0 KM	4301.00
STRS0021	21.0 KM	488.00	STRS0196	196.0 KM	1838.00	STRS0371	371.0 KM	3073.00	STRS0546	546.0 KM	4308.00
STRS0022	22.0 KM	498.00	STRS0197	197.0 KM	1845.00	STRS0372	372.0 KM	3080.00	STRS0547	547.0 KM	4315.00

SAP Service code	Lead in KM	Rate/MT	SAP Service code	Lead in KM	Rate/MT	SAP Service code	Lead in KM	Rate/MT	SAP Service code	Lead in KM	Rate/MT
STRS0023	23.0 KM	509.00	STRS0198	198.0 KM	1853.00	STRS0373	373.0 KM	3087.00	STRS0548	548.0 KM	4322.00
STRS0024	24.0 KM	520.00	STRS0199	199.0 KM	1860.00	STRS0374	374.0 KM	3094.00	STRS0549	549.0 KM	4329.00
STRS0025	25.0 KM	530.00	STRS0200	200.0 KM	1867.00	STRS0375	375.0 KM	3101.00	STRS0550	550.0 KM	4336.00
STRS0026	26.0 KM	541.00	STRS0201	201.0 KM	1874.00	STRS0376	376.0 KM	3109.00	STRS0551	551.0 KM	4343.00
STRS0027	27.0 KM	552.00	STRS0202	202.0 KM	1881.00	STRS0377	377.0 KM	3116.00	STRS0552	552.0 KM	4350.00
STRS0028	28.0 KM	562.00	STRS0203	203.0 KM	1888.00	STRS0378	378.0 KM	3123.00	STRS0553	553.0 KM	4357.00
STRS0029	29.0 KM	573.00	STRS0204	204.0 KM	1895.00	STRS0379	379.0 KM	3130.00	STRS0554	554.0 KM	4364.00
STRS0030	30.0 KM	584.00	STRS0205	205.0 KM	1902.00	STRS0380	380.0 KM	3137.00	STRS0555	555.0 KM	4372.00
STRS0031	31.0 KM	592.00	STRS0206	206.0 KM	1909.00	STRS0381	381.0 KM	3144.00	STRS0556	556.0 KM	4379.00
STRS0032	32.0 KM	601.00	STRS0207	207.0 KM	1916.00	STRS0382	382.0 KM	3151.00	STRS0557	557.0 KM	4386.00
STRS0033	33.0 KM	609.00	STRS0208	208.0 KM	1923.00	STRS0383	383.0 KM	3158.00	STRS0558	558.0 KM	4393.00
STRS0034	34.0 KM	618.00	STRS0209	209.0 KM	1930.00	STRS0384	384.0 KM	3165.00	STRS0559	559.0 KM	4400.00
STRS0035	35.0 KM	626.00	STRS0210	210.0 KM	1937.00	STRS0385	385.0 KM	3172.00	STRS0560	560.0 KM	4407.00
STRS0036	36.0 KM	635.00	STRS0211	211.0 KM	1944.00	STRS0386	386.0 KM	3179.00	STRS0561	561.0 KM	4414.00
STRS0037	37.0 KM	644.00	STRS0212	212.0 KM	1951.00	STRS0387	387.0 KM	3186.00	STRS0562	562.0 KM	4421.00
STRS0038	38.0 KM	652.00	STRS0213	213.0 KM	1958.00	STRS0388	388.0 KM	3193.00	STRS0563	563.0 KM	4428.00
STRS0039	39.0 KM	661.00	STRS0214	214.0 KM	1965.00	STRS0389	389.0 KM	3200.00	STRS0564	564.0 KM	4435.00
STRS0040	40.0 KM	669.00	STRS0215	215.0 KM	1972.00	STRS0390	390.0 KM	3207.00	STRS0565	565.0 KM	4442.00
STRS0041	41.0 KM	678.00	STRS0216	216.0 KM	1980.00	STRS0391	391.0 KM	3214.00	STRS0566	566.0 KM	4449.00
STRS0042	42.0 KM	686.00	STRS0217	217.0 KM	1987.00	STRS0392	392.0 KM	3221.00	STRS0567	567.0 KM	4456.00
STRS0043	43.0 KM	695.00	STRS0218	218.0 KM	1994.00	STRS0393	393.0 KM	3228.00	STRS0568	568.0 KM	4463.00
STRS0044	44.0 KM	703.00	STRS0219	219.0 KM	2001.00	STRS0394	394.0 KM	3236.00	STRS0569	569.0 KM	4470.00
STRS0045	45.0 KM	712.00	STRS0220	220.0 KM	2008.00	STRS0395	395.0 KM	3243.00	STRS0570	570.0 KM	4477.00
STRS0046	46.0 KM	721.00	STRS0221	221.0 KM	2015.00	STRS0396	396.0 KM	3250.00	STRS0571	571.0 KM	4484.00
STRS0047	47.0 KM	729.00	STRS0222	222.0 KM	2022.00	STRS0397	397.0 KM	3257.00	STRS0572	572.0 KM	4492.00
STRS0048	48.0 KM	738.00	STRS0223	223.0 KM	2029.00	STRS0398	398.0 KM	3264.00	STRS0573	573.0 KM	4499.00
STRS0049	49.0 KM	746.00	STRS0224	224.0 KM	2036.00	STRS0399	399.0 KM	3271.00	STRS0574	574.0 KM	4506.00
STRS0050	50.0 KM	755.00	STRS0225	225.0 KM	2043.00	STRS0400	400.0 KM	3278.00	STRS0575	575.0 KM	4513.00
STRS0051	51.0 KM	763.00	STRS0226	226.0 KM	2050.00	STRS0401	401.0 KM	3285.00	STRS0576	576.0 KM	4520.00
STRS0052	52.0 KM	772.00	STRS0227	227.0 KM	2057.00	STRS0402	402.0 KM	3292.00	STRS0577	577.0 KM	4527.00
STRS0053	53.0 KM	780.00	STRS0228	228.0 KM	2064.00	STRS0403	403.0 KM	3299.00	STRS0578	578.0 KM	4534.00

SAP Service code	Lead in KM	Rate/MT	SAP Service code	Lead in KM	Rate/MT	SAP Service code	Lead in KM	Rate/MT	SAP Service code	Lead in KM	Rate/MT
STRS0054	54.0 KM	789.00	STRS0229	229.0 KM	2071.00	STRS0404	404.0 KM	3306.00	STRS0579	579.0 KM	4541.00
STRS0055	55.0 KM	798.00	STRS0230	230.0 KM	2078.00	STRS0405	405.0 KM	3313.00	STRS0580	580.0 KM	4548.00
STRS0056	56.0 KM	806.00	STRS0231	231.0 KM	2085.00	STRS0406	406.0 KM	3320.00	STRS0581	581.0 KM	4555.00
STRS0057	57.0 KM	815.00	STRS0232	232.0 KM	2092.00	STRS0407	407.0 KM	3327.00	STRS0582	582.0 KM	4562.00
STRS0058	58.0 KM	823.00	STRS0233	233.0 KM	2099.00	STRS0408	408.0 KM	3334.00	STRS0583	583.0 KM	4569.00
STRS0059	59.0 KM	832.00	STRS0234	234.0 KM	2107.00	STRS0409	409.0 KM	3341.00	STRS0584	584.0 KM	4576.00
STRS0060	60.0 KM	840.00	STRS0235	235.0 KM	2114.00	STRS0410	410.0 KM	3348.00	STRS0585	585.0 KM	4583.00
STRS0061	61.0 KM	849.00	STRS0236	236.0 KM	2121.00	STRS0411	411.0 KM	3355.00	STRS0586	586.0 KM	4590.00
STRS0062	62.0 KM	857.00	STRS0237	237.0 KM	2128.00	STRS0412	412.0 KM	3363.00	STRS0587	587.0 KM	4597.00
STRS0063	63.0 KM	866.00	STRS0238	238.0 KM	2135.00	STRS0413	413.0 KM	3370.00	STRS0588	588.0 KM	4604.00
STRS0064	64.0 KM	875.00	STRS0239	239.0 KM	2142.00	STRS0414	414.0 KM	3377.00	STRS0589	589.0 KM	4611.00
STRS0065	65.0 KM	883.00	STRS0240	240.0 KM	2149.00	STRS0415	415.0 KM	3384.00	STRS0590	590.0 KM	4619.00
STRS0066	66.0 KM	892.00	STRS0241	241.0 KM	2156.00	STRS0416	416.0 KM	3391.00	STRS0591	591.0 KM	4626.00
STRS0067	67.0 KM	900.00	STRS0242	242.0 KM	2163.00	STRS0417	417.0 KM	3398.00	STRS0592	592.0 KM	4633.00
STRS0068	68.0 KM	909.00	STRS0243	243.0 KM	2170.00	STRS0418	418.0 KM	3405.00	STRS0593	593.0 KM	4640.00
STRS0069	69.0 KM	917.00	STRS0244	244.0 KM	2177.00	STRS0419	419.0 KM	3412.00	STRS0594	594.0 KM	4647.00
STRS0070	70.0 KM	926.00	STRS0245	245.0 KM	2184.00	STRS0420	420.0 KM	3419.00	STRS0595	595.0 KM	4654.00
STRS0071	71.0 KM	934.00	STRS0246	246.0 KM	2191.00	STRS0421	421.0 KM	3426.00	STRS0596	596.0 KM	4661.00
STRS0072	72.0 KM	943.00	STRS0247	247.0 KM	2198.00	STRS0422	422.0 KM	3433.00	STRS0597	597.0 KM	4668.00
STRS0073	73.0 KM	951.00	STRS0248	248.0 KM	2205.00	STRS0423	423.0 KM	3440.00	STRS0598	598.0 KM	4675.00
STRS0074	74.0 KM	960.00	STRS0249	249.0 KM	2212.00	STRS0424	424.0 KM	3447.00	STRS0599	599.0 KM	4682.00
STRS0075	75.0 KM	969.00	STRS0250	250.0 KM	2219.00	STRS0425	425.0 KM	3454.00	STRS0600	600.0 KM	4689.00
STRS0076	76.0 KM	977.00	STRS0251	251.0 KM	2227.00	STRS0426	426.0 KM	3461.00	STRS0601	601.0 KM	4696.00
STRS0077	77.0 KM	986.00	STRS0252	252.0 KM	2234.00	STRS0427	427.0 KM	3468.00	STRS0602	602.0 KM	4703.00
STRS0078	78.0 KM	994.00	STRS0253	253.0 KM	2241.00	STRS0428	428.0 KM	3475.00	STRS0603	603.0 KM	4710.00
STRS0079	79.0 KM	1003.00	STRS0254	254.0 KM	2248.00	STRS0429	429.0 KM	3482.00	STRS0604	604.0 KM	4717.00
STRS0080	80.0 KM	1011.00	STRS0255	255.0 KM	2255.00	STRS0430	430.0 KM	3490.00	STRS0605	605.0 KM	4724.00
STRS0081	81.0 KM	1019.00	STRS0256	256.0 KM	2262.00	STRS0431	431.0 KM	3497.00	STRS0606	606.0 KM	4731.00
STRS0082	82.0 KM	1026.00	STRS0257	257.0 KM	2269.00	STRS0432	432.0 KM	3504.00	STRS0607	607.0 KM	4738.00
STRS0083	83.0 KM	1034.00	STRS0258	258.0 KM	2276.00	STRS0433	433.0 KM	3511.00	STRS0608	608.0 KM	4746.00
STRS0084	84.0 KM	1041.00	STRS0259	259.0 KM	2283.00	STRS0434	434.0 KM	3518.00	STRS0609	609.0 KM	4753.00

SAP Service code	Lead in KM	Rate/MT	SAP Service code	Lead in KM	Rate/MT	SAP Service code	Lead in KM	Rate/MT	SAP Service code	Lead in KM	Rate/MT
STRS0085	85.0 KM	1049.00	STRS0260	260.0 KM	2290.00	STRS0435	435.0 KM	3525.00	STRS0610	610.0 KM	4760.00
STRS0086	86.0 KM	1056.00	STRS0261	261.0 KM	2297.00	STRS0436	436.0 KM	3532.00	STRS0611	611.0 KM	4767.00
STRS0087	87.0 KM	1064.00	STRS0262	262.0 KM	2304.00	STRS0437	437.0 KM	3539.00	STRS0612	612.0 KM	4774.00
STRS0088	88.0 KM	1071.00	STRS0263	263.0 KM	2311.00	STRS0438	438.0 KM	3546.00	STRS0613	613.0 KM	4781.00
STRS0089	89.0 KM	1079.00	STRS0264	264.0 KM	2318.00	STRS0439	439.0 KM	3553.00	STRS0614	614.0 KM	4788.00
STRS0090	90.0 KM	1086.00	STRS0265	265.0 KM	2325.00	STRS0440	440.0 KM	3560.00	STRS0615	615.0 KM	4795.00
STRS0091	91.0 KM	1094.00	STRS0266	266.0 KM	2332.00	STRS0441	441.0 KM	3567.00	STRS0616	616.0 KM	4802.00
STRS0092	92.0 KM	1101.00	STRS0267	267.0 KM	2339.00	STRS0442	442.0 KM	3574.00	STRS0617	617.0 KM	4809.00
STRS0093	93.0 KM	1109.00	STRS0268	268.0 KM	2346.00	STRS0443	443.0 KM	3581.00	STRS0618	618.0 KM	4816.00
STRS0094	94.0 KM	1116.00	STRS0269	269.0 KM	2354.00	STRS0444	444.0 KM	3588.00	STRS0619	619.0 KM	4823.00
STRS0095	95.0 KM	1124.00	STRS0270	270.0 KM	2361.00	STRS0445	445.0 KM	3595.00	STRS0620	620.0 KM	4830.00
STRS0096	96.0 KM	1131.00	STRS0271	271.0 KM	2368.00	STRS0446	446.0 KM	3602.00	STRS0621	621.0 KM	4837.00
STRS0097	97.0 KM	1139.00	STRS0272	272.0 KM	2375.00	STRS0447	447.0 KM	3609.00	STRS0622	622.0 KM	4844.00
STRS0098	98.0 KM	1146.00	STRS0273	273.0 KM	2382.00	STRS0448	448.0 KM	3617.00	STRS0623	623.0 KM	4851.00
STRS0099	99.0 KM	1154.00	STRS0274	274.0 KM	2389.00	STRS0449	449.0 KM	3624.00	STRS0624	624.0 KM	4858.00
STRS0100	100.0 KM	1161.00	STRS0275	275.0 KM	2396.00	STRS0450	450.0 KM	3631.00	STRS0625	625.0 KM	4865.00
STRS0101	101.0 KM	1168.00	STRS0276	276.0 KM	2403.00	STRS0451	451.0 KM	3638.00	STRS0626	626.0 KM	4873.00
STRS0102	102.0 KM	1175.00	STRS0277	277.0 KM	2410.00	STRS0452	452.0 KM	3645.00	STRS0627	627.0 KM	4880.00
STRS0103	103.0 KM	1182.00	STRS0278	278.0 KM	2417.00	STRS0453	453.0 KM	3652.00	STRS0628	628.0 KM	4887.00
STRS0104	104.0 KM	1189.00	STRS0279	279.0 KM	2424.00	STRS0454	454.0 KM	3659.00	STRS0629	629.0 KM	4894.00
STRS0105	105.0 KM	1196.00	STRS0280	280.0 KM	2431.00	STRS0455	455.0 KM	3666.00	STRS0630	630.0 KM	4901.00
STRS0106	106.0 KM	1203.00	STRS0281	281.0 KM	2438.00	STRS0456	456.0 KM	3673.00	STRS0631	631.0 KM	4908.00
STRS0107	107.0 KM	1210.00	STRS0282	282.0 KM	2445.00	STRS0457	457.0 KM	3680.00	STRS0632	632.0 KM	4915.00
STRS0108	108.0 KM	1217.00	STRS0283	283.0 KM	2452.00	STRS0458	458.0 KM	3687.00	STRS0633	633.0 KM	4922.00
STRS0109	109.0 KM	1225.00	STRS0284	284.0 KM	2459.00	STRS0459	459.0 KM	3694.00	STRS0634	634.0 KM	4929.00
STRS0110	110.0 KM	1232.00	STRS0285	285.0 KM	2466.00	STRS0460	460.0 KM	3701.00	STRS0635	635.0 KM	4936.00
STRS0111	111.0 KM	1239.00	STRS0286	286.0 KM	2473.00	STRS0461	461.0 KM	3708.00	STRS0636	636.0 KM	4943.00
STRS0112	112.0 KM	1246.00	STRS0287	287.0 KM	2481.00	STRS0462	462.0 KM	3715.00	STRS0637	637.0 KM	4950.00
STRS0113	113.0 KM	1253.00	STRS0288	288.0 KM	2488.00	STRS0463	463.0 KM	3722.00	STRS0638	638.0 KM	4957.00
STRS0114	114.0 KM	1260.00	STRS0289	289.0 KM	2495.00	STRS0464	464.0 KM	3729.00	STRS0639	639.0 KM	4964.00
STRS0115	115.0 KM	1267.00	STRS0290	290.0 KM	2502.00	STRS0465	465.0 KM	3737.00	STRS0640	640.0 KM	4971.00

SAP Service code	Lead in KM	Rate/MT	SAP Service code	Lead in KM	Rate/MT	SAP Service code	Lead in KM	Rate/MT	SAP Service code	Lead in KM	Rate/MT
STRS0116	116.0 KM	1274.00	STRS0291	291.0 KM	2509.00	STRS0466	466.0 KM	3744.00	STRS0641	641.0 KM	4978.00
STRS0117	117.0 KM	1281.00	STRS0292	292.0 KM	2516.00	STRS0467	467.0 KM	3751.00	STRS0642	642.0 KM	4985.00
STRS0118	118.0 KM	1288.00	STRS0293	293.0 KM	2523.00	STRS0468	468.0 KM	3758.00	STRS0643	643.0 KM	4992.00
STRS0119	119.0 KM	1295.00	STRS0294	294.0 KM	2530.00	STRS0469	469.0 KM	3765.00	STRS0644	644.0 KM	5000.00
STRS0120	120.0 KM	1302.00	STRS0295	295.0 KM	2537.00	STRS0470	470.0 KM	3772.00	STRS0645	645.0 KM	5007.00
STRS0121	121.0 KM	1309.00	STRS0296	296.0 KM	2544.00	STRS0471	471.0 KM	3779.00	STRS0646	646.0 KM	5014.00
STRS0122	122.0 KM	1316.00	STRS0297	297.0 KM	2551.00	STRS0472	472.0 KM	3786.00	STRS0647	647.0 KM	5021.00
STRS0123	123.0 KM	1323.00	STRS0298	298.0 KM	2558.00	STRS0473	473.0 KM	3793.00	STRS0648	648.0 KM	5028.00
STRS0124	124.0 KM	1330.00	STRS0299	299.0 KM	2565.00	STRS0474	474.0 KM	3800.00	STRS0649	649.0 KM	5035.00
STRS0125	125.0 KM	1337.00	STRS0300	300.0 KM	2572.00	STRS0475	475.0 KM	3807.00	STRS0650	650.0 KM	5042.00
STRS0126	126.0 KM	1345.00	STRS0301	301.0 KM	2579.00	STRS0476	476.0 KM	3814.00	STRS0651	651.0 KM	5049.00
STRS0127	127.0 KM	1352.00	STRS0302	302.0 KM	2586.00	STRS0477	477.0 KM	3821.00	STRS0652	652.0 KM	5056.00
STRS0128	128.0 KM	1359.00	STRS0303	303.0 KM	2593.00	STRS0478	478.0 KM	3828.00	STRS0653	653.0 KM	5063.00
STRS0129	129.0 KM	1366.00	STRS0304	304.0 KM	2600.00	STRS0479	479.0 KM	3835.00	STRS0654	654.0 KM	5070.00
STRS0130	130.0 KM	1373.00	STRS0305	305.0 KM	2608.00	STRS0480	480.0 KM	3842.00	STRS0655	655.0 KM	5077.00
STRS0131	131.0 KM	1380.00	STRS0306	306.0 KM	2615.00	STRS0481	481.0 KM	3849.00	STRS0656	656.0 KM	5084.00
STRS0132	132.0 KM	1387.00	STRS0307	307.0 KM	2622.00	STRS0482	482.0 KM	3856.00	STRS0657	657.0 KM	5091.00
STRS0133	133.0 KM	1394.00	STRS0308	308.0 KM	2629.00	STRS0483	483.0 KM	3864.00	STRS0658	658.0 KM	5098.00
STRS0134	134.0 KM	1401.00	STRS0309	309.0 KM	2636.00	STRS0484	484.0 KM	3871.00	STRS0659	659.0 KM	5105.00
STRS0135	135.0 KM	1408.00	STRS0310	310.0 KM	2643.00	STRS0485	485.0 KM	3878.00	STRS0660	660.0 KM	5112.00
STRS0136	136.0 KM	1415.00	STRS0311	311.0 KM	2650.00	STRS0486	486.0 KM	3885.00	STRS0661	661.0 KM	5119.00
STRS0137	137.0 KM	1422.00	STRS0312	312.0 KM	2657.00	STRS0487	487.0 KM	3892.00	STRS0662	662.0 KM	5127.00
STRS0138	138.0 KM	1429.00	STRS0313	313.0 KM	2664.00	STRS0488	488.0 KM	3899.00	STRS0663	663.0 KM	5134.00
STRS0139	139.0 KM	1436.00	STRS0314	314.0 KM	2671.00	STRS0489	489.0 KM	3906.00	STRS0664	664.0 KM	5141.00
STRS0140	140.0 KM	1443.00	STRS0315	315.0 KM	2678.00	STRS0490	490.0 KM	3913.00	STRS0665	665.0 KM	5148.00
STRS0141	141.0 KM	1450.00	STRS0316	316.0 KM	2685.00	STRS0491	491.0 KM	3920.00	STRS0666	666.0 KM	5155.00
STRS0142	142.0 KM	1457.00	STRS0317	317.0 KM	2692.00	STRS0492	492.0 KM	3927.00	STRS0667	667.0 KM	5162.00
STRS0143	143.0 KM	1464.00	STRS0318	318.0 KM	2699.00	STRS0493	493.0 KM	3934.00	STRS0668	668.0 KM	5169.00
STRS0144	144.0 KM	1472.00	STRS0319	319.0 KM	2706.00	STRS0494	494.0 KM	3941.00	STRS0669	669.0 KM	5176.00
STRS0145	145.0 KM	1479.00	STRS0320	320.0 KM	2713.00	STRS0495	495.0 KM	3948.00	STRS0670	670.0 KM	5183.00
STRS0146	146.0 KM	1486.00	STRS0321	321.0 KM	2720.00	STRS0496	496.0 KM	3955.00	STRS0671	671.0 KM	5190.00

SAP Service code	Lead in KM	Rate/MT	SAP Service code	Lead in KM	Rate/MT	SAP Service code	Lead in KM	Rate/MT	SAP Service code	Lead in KM	Rate/MT
STRS0147	147.0 KM	1493.00	STRS0322	322.0 KM	2727.00	STRS0497	497.0 KM	3962.00	STRS0672	672.0 KM	5197.00
STRS0148	148.0 KM	1500.00	STRS0323	323.0 KM	2735.00	STRS0498	498.0 KM	3969.00	STRS0673	673.0 KM	5204.00
STRS0149	149.0 KM	1507.00	STRS0324	324.0 KM	2742.00	STRS0499	499.0 KM	3976.00	STRS0674	674.0 KM	5211.00
STRS0150	150.0 KM	1514.00	STRS0325	325.0 KM	2749.00	STRS0500	500.0 KM	3983.00	STRS0675	675.0 KM	5218.00
STRS0151	151.0 KM	1521.00	STRS0326	326.0 KM	2756.00	STRS0501	501.0 KM	3991.00	STRS0676	676.0 KM	5225.00
STRS0152	152.0 KM	1528.00	STRS0327	327.0 KM	2763.00	STRS0502	502.0 KM	3998.00	STRS0677	677.0 KM	5232.00
STRS0153	153.0 KM	1535.00	STRS0328	328.0 KM	2770.00	STRS0503	503.0 KM	4005.00	STRS0678	678.0 KM	5239.00
STRS0154	154.0 KM	1542.00	STRS0329	329.0 KM	2777.00	STRS0504	504.0 KM	4012.00	STRS0679	679.0 KM	5247.00
STRS0155	155.0 KM	1549.00	STRS0330	330.0 KM	2784.00	STRS0505	505.0 KM	4019.00	STRS0680	680.0 KM	5254.00
STRS0156	156.0 KM	1556.00	STRS0331	331.0 KM	2791.00	STRS0506	506.0 KM	4026.00	STRS0681	681.0 KM	5261.00
STRS0157	157.0 KM	1563.00	STRS0332	332.0 KM	2798.00	STRS0507	507.0 KM	4033.00	STRS0682	682.0 KM	5268.00
STRS0158	158.0 KM	1570.00	STRS0333	333.0 KM	2805.00	STRS0508	508.0 KM	4040.00	STRS0683	683.0 KM	5275.00
STRS0159	159.0 KM	1577.00	STRS0334	334.0 KM	2812.00	STRS0509	509.0 KM	4047.00	STRS0684	684.0 KM	5282.00
STRS0160	160.0 KM	1584.00	STRS0335	335.0 KM	2819.00	STRS0510	510.0 KM	4054.00	STRS0685	685.0 KM	5289.00
STRS0161	161.0 KM	1591.00	STRS0336	336.0 KM	2826.00	STRS0511	511.0 KM	4061.00	STRS0686	686.0 KM	5296.00
STRS0162	162.0 KM	1599.00	STRS0337	337.0 KM	2833.00	STRS0512	512.0 KM	4068.00	STRS0687	687.0 KM	5303.00
STRS0163	163.0 KM	1606.00	STRS0338	338.0 KM	2840.00	STRS0513	513.0 KM	4075.00	STRS0688	688.0 KM	5310.00
STRS0164	164.0 KM	1613.00	STRS0339	339.0 KM	2847.00	STRS0514	514.0 KM	4082.00	STRS0689	689.0 KM	5317.00
STRS0165	165.0 KM	1620.00	STRS0340	340.0 KM	2854.00	STRS0515	515.0 KM	4089.00	STRS0690	690.0 KM	5324.00
STRS0166	166.0 KM	1627.00	STRS0341	341.0 KM	2862.00	STRS0516	516.0 KM	4096.00	STRS0691	691.0 KM	5331.00
STRS0167	167.0 KM	1634.00	STRS0342	342.0 KM	2869.00	STRS0517	517.0 KM	4103.00	STRS0692	692.0 KM	5338.00
STRS0168	168.0 KM	1641.00	STRS0343	343.0 KM	2876.00	STRS0518	518.0 KM	4110.00	STRS0693	693.0 KM	5345.00
STRS0169	169.0 KM	1648.00	STRS0344	344.0 KM	2883.00	STRS0519	519.0 KM	4118.00	STRS0694	694.0 KM	5352.00
STRS0170	170.0 KM	1655.00	STRS0345	345.0 KM	2890.00	STRS0520	520.0 KM	4125.00	STRS0695	695.0 KM	5359.00
STRS0171	171.0 KM	1662.00	STRS0346	346.0 KM	2897.00	STRS0521	521.0 KM	4132.00	STRS0696	696.0 KM	5366.00
STRS0172	172.0 KM	1669.00	STRS0347	347.0 KM	2904.00	STRS0522	522.0 KM	4139.00	STRS0697	697.0 KM	5374.00
STRS0173	173.0 KM	1676.00	STRS0348	348.0 KM	2911.00	STRS0523	523.0 KM	4146.00	STRS0698	698.0 KM	5381.00
STRS0174	174.0 KM	1683.00	STRS0349	349.0 KM	2918.00	STRS0524	524.0 KM	4153.00	STRS0699	699.0 KM	5388.00
STRS0175	175.0 KM	1690.00	STRS0350	350.0 KM	2925.00	STRS0525	525.0 KM	4160.00	STRS0700	700.0 KM	5395.00

3.TRANSPORT OF LINE MATERIALS :-

SAP Service code	Lead in KM	Rate/MT	SAP Service code	Lead in KM	Rate/MT	SAP Service code	Lead in KM	Rate/MT	SAP Service code	Lead in KM	Rate/MT
STRL0001	1.0 KM	221.00	STRL0176	176.0 KM	1189.00	STRL0351	351.0 KM	2307.00	STRL0526	526.0 KM	3221.00
STRL0002	2.0 KM	232.00	STRL0177	177.0 KM	1193.00	STRL0352	352.0 KM	2312.00	STRL0527	527.0 KM	3226.00
STRL0003	3.0 KM	241.00	STRL0178	178.0 KM	1197.00	STRL0353	353.0 KM	2318.00	STRL0528	528.0 KM	3231.00
STRL0004	4.0 KM	252.00	STRL0179	179.0 KM	1202.00	STRL0354	354.0 KM	2323.00	STRL0529	529.0 KM	3236.00
STRL0005	5.0 KM	262.00	STRL0180	180.0 KM	1206.00	STRL0355	355.0 KM	2328.00	STRL0530	530.0 KM	3240.00
STRL0006	6.0 KM	272.00	STRL0181	181.0 KM	1210.00	STRL0356	356.0 KM	2334.00	STRL0531	531.0 KM	3245.00
STRL0007	7.0 KM	282.00	STRL0182	182.0 KM	1214.00	STRL0357	357.0 KM	2339.00	STRL0532	532.0 KM	3250.00
STRL0008	8.0 KM	292.00	STRL0183	183.0 KM	1219.00	STRL0358	358.0 KM	2345.00	STRL0533	533.0 KM	3255.00
STRL0009	9.0 KM	298.00	STRL0184	184.0 KM	1223.00	STRL0359	359.0 KM	2350.00	STRL0534	534.0 KM	3260.00
STRL0010	10.0 KM	307.00	STRL0185	185.0 KM	1227.00	STRL0360	360.0 KM	2355.00	STRL0535	535.0 KM	3265.00
STRL0011	11.0 KM	316.00	STRL0186	186.0 KM	1232.00	STRL0361	361.0 KM	2361.00	STRL0536	536.0 KM	3270.00
STRL0012	12.0 KM	336.00	STRL0187	187.0 KM	1236.00	STRL0362	362.0 KM	2366.00	STRL0537	537.0 KM	3275.00
STRL0013	13.0 KM	341.00	STRL0188	188.0 KM	1240.00	STRL0363	363.0 KM	2371.00	STRL0538	538.0 KM	3280.00
STRL0014	14.0 KM	345.00	STRL0189	189.0 KM	1244.00	STRL0364	364.0 KM	2377.00	STRL0539	539.0 KM	3285.00
STRL0015	15.0 KM	353.00	STRL0190	190.0 KM	1249.00	STRL0365	365.0 KM	2382.00	STRL0540	540.0 KM	3290.00
STRL0016	16.0 KM	357.00	STRL0191	191.0 KM	1253.00	STRL0366	366.0 KM	2387.00	STRL0541	541.0 KM	3295.00
STRL0017	17.0 KM	362.00	STRL0192	192.0 KM	1257.00	STRL0367	367.0 KM	2393.00	STRL0542	542.0 KM	3299.00
STRL0018	18.0 KM	367.00	STRL0193	193.0 KM	1262.00	STRL0368	368.0 KM	2398.00	STRL0543	543.0 KM	3304.00
STRL0019	19.0 KM	380.00	STRL0194	194.0 KM	1266.00	STRL0369	369.0 KM	2403.00	STRL0544	544.0 KM	3309.00
STRL0020	20.0 KM	388.00	STRL0195	195.0 KM	1270.00	STRL0370	370.0 KM	2409.00	STRL0545	545.0 KM	3314.00
STRL0021	21.0 KM	395.00	STRL0196	196.0 KM	1274.00	STRL0371	371.0 KM	2414.00	STRL0546	546.0 KM	3319.00
STRL0022	22.0 KM	403.00	STRL0197	197.0 KM	1279.00	STRL0372	372.0 KM	2419.00	STRL0547	547.0 KM	3324.00
STRL0023	23.0 KM	410.00	STRL0198	198.0 KM	1283.00	STRL0373	373.0 KM	2425.00	STRL0548	548.0 KM	3329.00
STRL0024	24.0 KM	417.00	STRL0199	199.0 KM	1287.00	STRL0374	374.0 KM	2430.00	STRL0549	549.0 KM	3334.00
STRL0025	25.0 KM	424.00	STRL0200	200.0 KM	1291.00	STRL0375	375.0 KM	2435.00	STRL0550	550.0 KM	3339.00
STRL0026	26.0 KM	432.00	STRL0201	201.0 KM	1296.00	STRL0376	376.0 KM	2441.00	STRL0551	551.0 KM	3344.00
STRL0027	27.0 KM	439.00	STRL0202	202.0 KM	1300.00	STRL0377	377.0 KM	2446.00	STRL0552	552.0 KM	3349.00
STRL0028	28.0 KM	446.00	STRL0203	203.0 KM	1304.00	STRL0378	378.0 KM	2451.00	STRL0553	553.0 KM	3354.00

SAP Service code	Lead in KM	Rate/MT	SAP Service code	Lead in KM	Rate/MT	SAP Service code	Lead in KM	Rate/MT	SAP Service code	Lead in KM	Rate/MT
STRL0029	29.0 KM	454.00	STRL0204	204.0 KM	1309.00	STRL0379	379.0 KM	2457.00	STRL0554	554.0 KM	3358.00
STRL0030	30.0 KM	461.00	STRL0205	205.0 KM	1313.00	STRL0380	380.0 KM	2462.00	STRL0555	555.0 KM	3363.00
STRL0031	31.0 KM	467.00	STRL0206	206.0 KM	1317.00	STRL0381	381.0 KM	2467.00	STRL0556	556.0 KM	3368.00
STRL0032	32.0 KM	474.00	STRL0207	207.0 KM	1321.00	STRL0382	382.0 KM	2473.00	STRL0557	557.0 KM	3373.00
STRL0033	33.0 KM	480.00	STRL0208	208.0 KM	1326.00	STRL0383	383.0 KM	2478.00	STRL0558	558.0 KM	3378.00
STRL0034	34.0 KM	486.00	STRL0209	209.0 KM	1330.00	STRL0384	384.0 KM	2484.00	STRL0559	559.0 KM	3383.00
STRL0035	35.0 KM	493.00	STRL0210	210.0 KM	1334.00	STRL0385	385.0 KM	2489.00	STRL0560	560.0 KM	3388.00
STRL0036	36.0 KM	499.00	STRL0211	211.0 KM	1339.00	STRL0386	386.0 KM	2494.00	STRL0561	561.0 KM	3393.00
STRL0037	37.0 KM	506.00	STRL0212	212.0 KM	1343.00	STRL0387	387.0 KM	2500.00	STRL0562	562.0 KM	3398.00
STRL0038	38.0 KM	512.00	STRL0213	213.0 KM	1347.00	STRL0388	388.0 KM	2505.00	STRL0563	563.0 KM	3403.00
STRL0039	39.0 KM	519.00	STRL0214	214.0 KM	1351.00	STRL0389	389.0 KM	2510.00	STRL0564	564.0 KM	3408.00
STRL0040	40.0 KM	525.00	STRL0215	215.0 KM	1356.00	STRL0390	390.0 KM	2516.00	STRL0565	565.0 KM	3413.00
STRL0041	41.0 KM	531.00	STRL0216	216.0 KM	1360.00	STRL0391	391.0 KM	2521.00	STRL0566	566.0 KM	3417.00
STRL0042	42.0 KM	538.00	STRL0217	217.0 KM	1364.00	STRL0392	392.0 KM	2526.00	STRL0567	567.0 KM	3422.00
STRL0043	43.0 KM	544.00	STRL0218	218.0 KM	1368.00	STRL0393	393.0 KM	2532.00	STRL0568	568.0 KM	3427.00
STRL0044	44.0 KM	551.00	STRL0219	219.0 KM	1373.00	STRL0394	394.0 KM	2537.00	STRL0569	569.0 KM	3432.00
STRL0045	45.0 KM	557.00	STRL0220	220.0 KM	1377.00	STRL0395	395.0 KM	2542.00	STRL0570	570.0 KM	3437.00
STRL0046	46.0 KM	563.00	STRL0221	221.0 KM	1381.00	STRL0396	396.0 KM	2548.00	STRL0571	571.0 KM	3442.00
STRL0047	47.0 KM	570.00	STRL0222	222.0 KM	1386.00	STRL0397	397.0 KM	2553.00	STRL0572	572.0 KM	3447.00
STRL0048	48.0 KM	576.00	STRL0223	223.0 KM	1390.00	STRL0398	398.0 KM	2558.00	STRL0573	573.0 KM	3452.00
STRL0049	49.0 KM	583.00	STRL0224	224.0 KM	1394.00	STRL0399	399.0 KM	2564.00	STRL0574	574.0 KM	3457.00
STRL0050	50.0 KM	589.00	STRL0225	225.0 KM	1398.00	STRL0400	400.0 KM	2569.00	STRL0575	575.0 KM	3462.00
STRL0051	51.0 KM	595.00	STRL0226	226.0 KM	1403.00	STRL0401	401.0 KM	2574.00	STRL0576	576.0 KM	3467.00
STRL0052	52.0 KM	601.00	STRL0227	227.0 KM	1407.00	STRL0402	402.0 KM	2580.00	STRL0577	577.0 KM	3472.00
STRL0053	53.0 KM	607.00	STRL0228	228.0 KM	1411.00	STRL0403	403.0 KM	2585.00	STRL0578	578.0 KM	3476.00
STRL0054	54.0 KM	613.00	STRL0229	229.0 KM	1415.00	STRL0404	404.0 KM	2590.00	STRL0579	579.0 KM	3481.00
STRL0055	55.0 KM	618.00	STRL0230	230.0 KM	1420.00	STRL0405	405.0 KM	2595.00	STRL0580	580.0 KM	3486.00
STRL0056	56.0 KM	624.00	STRL0231	231.0 KM	1424.00	STRL0406	406.0 KM	2600.00	STRL0581	581.0 KM	3491.00
STRL0057	57.0 KM	630.00	STRL0232	232.0 KM	1428.00	STRL0407	407.0 KM	2606.00	STRL0582	582.0 KM	3496.00
STRL0058	58.0 KM	636.00	STRL0233	233.0 KM	1433.00	STRL0408	408.0 KM	2611.00	STRL0583	583.0 KM	3501.00
STRL0059	59.0 KM	642.00	STRL0234	234.0 KM	1437.00	STRL0409	409.0 KM	2616.00	STRL0584	584.0 KM	3506.00

SAP Service code	Lead in KM	Rate/MT	SAP Service code	Lead in KM	Rate/MT	SAP Service code	Lead in KM	Rate/MT	SAP Service code	Lead in KM	Rate/MT
STRL0060	60.0 KM	648.00	STRL0235	235.0 KM	1441.00	STRL0410	410.0 KM	2621.00	STRL0585	585.0 KM	3511.00
STRL0061	61.0 KM	654.00	STRL0236	236.0 KM	1445.00	STRL0411	411.0 KM	2627.00	STRL0586	586.0 KM	3516.00
STRL0062	62.0 KM	660.00	STRL0237	237.0 KM	1450.00	STRL0412	412.0 KM	2632.00	STRL0587	587.0 KM	3521.00
STRL0063	63.0 KM	666.00	STRL0238	238.0 KM	1454.00	STRL0413	413.0 KM	2637.00	STRL0588	588.0 KM	3526.00
STRL0064	64.0 KM	671.00	STRL0239	239.0 KM	1458.00	STRL0414	414.0 KM	2642.00	STRL0589	589.0 KM	3531.00
STRL0065	65.0 KM	677.00	STRL0240	240.0 KM	1463.00	STRL0415	415.0 KM	2648.00	STRL0590	590.0 KM	3536.00
STRL0066	66.0 KM	683.00	STRL0241	241.0 KM	1467.00	STRL0416	416.0 KM	2653.00	STRL0591	591.0 KM	3540.00
STRL0067	67.0 KM	689.00	STRL0242	242.0 KM	1471.00	STRL0417	417.0 KM	2658.00	STRL0592	592.0 KM	3545.00
STRL0068	68.0 KM	695.00	STRL0243	243.0 KM	1475.00	STRL0418	418.0 KM	2663.00	STRL0593	593.0 KM	3550.00
STRL0069	69.0 KM	701.00	STRL0244	244.0 KM	1480.00	STRL0419	419.0 KM	2669.00	STRL0594	594.0 KM	3555.00
STRL0070	70.0 KM	707.00	STRL0245	245.0 KM	1484.00	STRL0420	420.0 KM	2674.00	STRL0595	595.0 KM	3560.00
STRL0071	71.0 KM	713.00	STRL0246	246.0 KM	1488.00	STRL0421	421.0 KM	2679.00	STRL0596	596.0 KM	3565.00
STRL0072	72.0 KM	718.00	STRL0247	247.0 KM	1492.00	STRL0422	422.0 KM	2684.00	STRL0597	597.0 KM	3570.00
STRL0073	73.0 KM	724.00	STRL0248	248.0 KM	1497.00	STRL0423	423.0 KM	2690.00	STRL0598	598.0 KM	3575.00
STRL0074	74.0 KM	730.00	STRL0249	249.0 KM	1501.00	STRL0424	424.0 KM	2695.00	STRL0599	599.0 KM	3580.00
STRL0075	75.0 KM	736.00	STRL0250	250.0 KM	1505.00	STRL0425	425.0 KM	2700.00	STRL0600	600.0 KM	3585.00
STRL0076	76.0 KM	742.00	STRL0251	251.0 KM	1746.00	STRL0426	426.0 KM	2705.00	STRL0601	601.0 KM	3590.00
STRL0077	77.0 KM	748.00	STRL0252	252.0 KM	1752.00	STRL0427	427.0 KM	2710.00	STRL0602	602.0 KM	3595.00
STRL0078	78.0 KM	754.00	STRL0253	253.0 KM	1758.00	STRL0428	428.0 KM	2716.00	STRL0603	603.0 KM	3599.00
STRL0079	79.0 KM	760.00	STRL0254	254.0 KM	1764.00	STRL0429	429.0 KM	2721.00	STRL0604	604.0 KM	3604.00
STRL0080	80.0 KM	765.00	STRL0255	255.0 KM	1770.00	STRL0430	430.0 KM	2726.00	STRL0605	605.0 KM	3609.00
STRL0081	81.0 KM	770.00	STRL0256	256.0 KM	1776.00	STRL0431	431.0 KM	2731.00	STRL0606	606.0 KM	3614.00
STRL0082	82.0 KM	775.00	STRL0257	257.0 KM	1782.00	STRL0432	432.0 KM	2737.00	STRL0607	607.0 KM	3619.00
STRL0083	83.0 KM	780.00	STRL0258	258.0 KM	1788.00	STRL0433	433.0 KM	2742.00	STRL0608	608.0 KM	3624.00
STRL0084	84.0 KM	785.00	STRL0259	259.0 KM	1793.00	STRL0434	434.0 KM	2747.00	STRL0609	609.0 KM	3629.00
STRL0085	85.0 KM	790.00	STRL0260	260.0 KM	1799.00	STRL0435	435.0 KM	2752.00	STRL0610	610.0 KM	3634.00
STRL0086	86.0 KM	795.00	STRL0261	261.0 KM	1805.00	STRL0436	436.0 KM	2758.00	STRL0611	611.0 KM	3639.00
STRL0087	87.0 KM	800.00	STRL0262	262.0 KM	1811.00	STRL0437	437.0 KM	2763.00	STRL0612	612.0 KM	3644.00
STRL0088	88.0 KM	805.00	STRL0263	263.0 KM	1817.00	STRL0438	438.0 KM	2768.00	STRL0613	613.0 KM	3649.00
STRL0089	89.0 KM	810.00	STRL0264	264.0 KM	1823.00	STRL0439	439.0 KM	2773.00	STRL0614	614.0 KM	3654.00
STRL0090	90.0 KM	815.00	STRL0265	265.0 KM	1829.00	STRL0440	440.0 KM	2779.00	STRL0615	615.0 KM	3658.00

SAP Service code	Lead in KM	Rate/MT	SAP Service code	Lead in KM	Rate/MT	SAP Service code	Lead in KM	Rate/MT	SAP Service code	Lead in KM	Rate/MT
STRL0091	91.0 KM	820.00	STRL0266	266.0 KM	1835.00	STRL0441	441.0 KM	2784.00	STRL0616	616.0 KM	3663.00
STRL0092	92.0 KM	824.00	STRL0267	267.0 KM	1840.00	STRL0442	442.0 KM	2789.00	STRL0617	617.0 KM	3668.00
STRL0093	93.0 KM	829.00	STRL0268	268.0 KM	1846.00	STRL0443	443.0 KM	2794.00	STRL0618	618.0 KM	3673.00
STRL0094	94.0 KM	834.00	STRL0269	269.0 KM	1852.00	STRL0444	444.0 KM	2800.00	STRL0619	619.0 KM	3678.00
STRL0095	95.0 KM	839.00	STRL0270	270.0 KM	1858.00	STRL0445	445.0 KM	2805.00	STRL0620	620.0 KM	3683.00
STRL0096	96.0 KM	844.00	STRL0271	271.0 KM	1864.00	STRL0446	446.0 KM	2810.00	STRL0621	621.0 KM	3688.00
STRL0097	97.0 KM	849.00	STRL0272	272.0 KM	1870.00	STRL0447	447.0 KM	2815.00	STRL0622	622.0 KM	3693.00
STRL0098	98.0 KM	854.00	STRL0273	273.0 KM	1876.00	STRL0448	448.0 KM	2820.00	STRL0623	623.0 KM	3698.00
STRL0099	99.0 KM	859.00	STRL0274	274.0 KM	1882.00	STRL0449	449.0 KM	2826.00	STRL0624	624.0 KM	3703.00
STRL0100	100.0 KM	864.00	STRL0275	275.0 KM	1887.00	STRL0450	450.0 KM	2831.00	STRL0625	625.0 KM	3708.00
STRL0101	101.0 KM	868.00	STRL0276	276.0 KM	1893.00	STRL0451	451.0 KM	2836.00	STRL0626	626.0 KM	3713.00
STRL0102	102.0 KM	872.00	STRL0277	277.0 KM	1899.00	STRL0452	452.0 KM	2841.00	STRL0627	627.0 KM	3717.00
STRL0103	103.0 KM	877.00	STRL0278	278.0 KM	1905.00	STRL0453	453.0 KM	2847.00	STRL0628	628.0 KM	3722.00
STRL0104	104.0 KM	881.00	STRL0279	279.0 KM	1911.00	STRL0454	454.0 KM	2852.00	STRL0629	629.0 KM	3727.00
STRL0105	105.0 KM	885.00	STRL0280	280.0 KM	1917.00	STRL0455	455.0 KM	2857.00	STRL0630	630.0 KM	3732.00
STRL0106	106.0 KM	889.00	STRL0281	281.0 KM	1923.00	STRL0456	456.0 KM	2862.00	STRL0631	631.0 KM	3737.00
STRL0107	107.0 KM	894.00	STRL0282	282.0 KM	1929.00	STRL0457	457.0 KM	2868.00	STRL0632	632.0 KM	3742.00
STRL0108	108.0 KM	898.00	STRL0283	283.0 KM	1935.00	STRL0458	458.0 KM	2873.00	STRL0633	633.0 KM	3747.00
STRL0109	109.0 KM	902.00	STRL0284	284.0 KM	1940.00	STRL0459	459.0 KM	2878.00	STRL0634	634.0 KM	3752.00
STRL0110	110.0 KM	907.00	STRL0285	285.0 KM	1946.00	STRL0460	460.0 KM	2883.00	STRL0635	635.0 KM	3757.00
STRL0111	111.0 KM	911.00	STRL0286	286.0 KM	1952.00	STRL0461	461.0 KM	2889.00	STRL0636	636.0 KM	3762.00
STRL0112	112.0 KM	915.00	STRL0287	287.0 KM	1958.00	STRL0462	462.0 KM	2894.00	STRL0637	637.0 KM	3767.00
STRL0113	113.0 KM	919.00	STRL0288	288.0 KM	1964.00	STRL0463	463.0 KM	2899.00	STRL0638	638.0 KM	3772.00
STRL0114	114.0 KM	924.00	STRL0289	289.0 KM	1970.00	STRL0464	464.0 KM	2904.00	STRL0639	639.0 KM	3776.00
STRL0115	115.0 KM	928.00	STRL0290	290.0 KM	1976.00	STRL0465	465.0 KM	2910.00	STRL0640	640.0 KM	3781.00
STRL0116	116.0 KM	932.00	STRL0291	291.0 KM	1982.00	STRL0466	466.0 KM	2915.00	STRL0641	641.0 KM	3786.00
STRL0117	117.0 KM	937.00	STRL0292	292.0 KM	1987.00	STRL0467	467.0 KM	2920.00	STRL0642	642.0 KM	3791.00
STRL0118	118.0 KM	941.00	STRL0293	293.0 KM	1993.00	STRL0468	468.0 KM	2925.00	STRL0643	643.0 KM	3796.00
STRL0119	119.0 KM	945.00	STRL0294	294.0 KM	1999.00	STRL0469	469.0 KM	2931.00	STRL0644	644.0 KM	3801.00
STRL0120	120.0 KM	949.00	STRL0295	295.0 KM	2005.00	STRL0470	470.0 KM	2936.00	STRL0645	645.0 KM	3806.00
STRL0121	121.0 KM	954.00	STRL0296	296.0 KM	2011.00	STRL0471	471.0 KM	2941.00	STRL0646	646.0 KM	3811.00

SAP Service code	Lead in KM	Rate/MT	SAP Service code	Lead in KM	Rate/MT	SAP Service code	Lead in KM	Rate/MT	SAP Service code	Lead in KM	Rate/MT
STRL0122	122.0 KM	958.00	STRL0297	297.0 KM	2017.00	STRL0472	472.0 KM	2946.00	STRL0647	647.0 KM	3816.00
STRL0123	123.0 KM	962.00	STRL0298	298.0 KM	2023.00	STRL0473	473.0 KM	2951.00	STRL0648	648.0 KM	3821.00
STRL0124	124.0 KM	966.00	STRL0299	299.0 KM	2029.00	STRL0474	474.0 KM	2957.00	STRL0649	649.0 KM	3826.00
STRL0125	125.0 KM	971.00	STRL0300	300.0 KM	2034.00	STRL0475	475.0 KM	2962.00	STRL0650	650.0 KM	3831.00
STRL0126	126.0 KM	975.00	STRL0301	301.0 KM	2040.00	STRL0476	476.0 KM	2967.00	STRL0651	651.0 KM	3836.00
STRL0127	127.0 KM	979.00	STRL0302	302.0 KM	2045.00	STRL0477	477.0 KM	2972.00	STRL0652	652.0 KM	3840.00
STRL0128	128.0 KM	984.00	STRL0303	303.0 KM	2051.00	STRL0478	478.0 KM	2978.00	STRL0653	653.0 KM	3845.00
STRL0129	129.0 KM	988.00	STRL0304	304.0 KM	2056.00	STRL0479	479.0 KM	2983.00	STRL0654	654.0 KM	3850.00
STRL0130	130.0 KM	992.00	STRL0305	305.0 KM	2061.00	STRL0480	480.0 KM	2988.00	STRL0655	655.0 KM	3855.00
STRL0131	131.0 KM	996.00	STRL0306	306.0 KM	2067.00	STRL0481	481.0 KM	2993.00	STRL0656	656.0 KM	3860.00
STRL0132	132.0 KM	1001.00	STRL0307	307.0 KM	2072.00	STRL0482	482.0 KM	2999.00	STRL0657	657.0 KM	3865.00
STRL0133	133.0 KM	1005.00	STRL0308	308.0 KM	2077.00	STRL0483	483.0 KM	3004.00	STRL0658	658.0 KM	3870.00
STRL0134	134.0 KM	1009.00	STRL0309	309.0 KM	2083.00	STRL0484	484.0 KM	3009.00	STRL0659	659.0 KM	3875.00
STRL0135	135.0 KM	1014.00	STRL0310	310.0 KM	2088.00	STRL0485	485.0 KM	3014.00	STRL0660	660.0 KM	3880.00
STRL0136	136.0 KM	1018.00	STRL0311	311.0 KM	2093.00	STRL0486	486.0 KM	3020.00	STRL0661	661.0 KM	3885.00
STRL0137	137.0 KM	1022.00	STRL0312	312.0 KM	2099.00	STRL0487	487.0 KM	3025.00	STRL0662	662.0 KM	3890.00
STRL0138	138.0 KM	1026.00	STRL0313	313.0 KM	2104.00	STRL0488	488.0 KM	3030.00	STRL0663	663.0 KM	3895.00
STRL0139	139.0 KM	1031.00	STRL0314	314.0 KM	2109.00	STRL0489	489.0 KM	3035.00	STRL0664	664.0 KM	3899.00
STRL0140	140.0 KM	1035.00	STRL0315	315.0 KM	2115.00	STRL0490	490.0 KM	3041.00	STRL0665	665.0 KM	3904.00
STRL0141	141.0 KM	1039.00	STRL0316	316.0 KM	2120.00	STRL0491	491.0 KM	3046.00	STRL0666	666.0 KM	3909.00
STRL0142	142.0 KM	1043.00	STRL0317	317.0 KM	2125.00	STRL0492	492.0 KM	3051.00	STRL0667	667.0 KM	3914.00
STRL0143	143.0 KM	1048.00	STRL0318	318.0 KM	2131.00	STRL0493	493.0 KM	3056.00	STRL0668	668.0 KM	3919.00
STRL0144	144.0 KM	1052.00	STRL0319	319.0 KM	2136.00	STRL0494	494.0 KM	3061.00	STRL0669	669.0 KM	3924.00
STRL0145	145.0 KM	1056.00	STRL0320	320.0 KM	2141.00	STRL0495	495.0 KM	3067.00	STRL0670	670.0 KM	3929.00
STRL0146	146.0 KM	1061.00	STRL0321	321.0 KM	2147.00	STRL0496	496.0 KM	3072.00	STRL0671	671.0 KM	3934.00
STRL0147	147.0 KM	1065.00	STRL0322	322.0 KM	2152.00	STRL0497	497.0 KM	3077.00	STRL0672	672.0 KM	3939.00
STRL0148	148.0 KM	1069.00	STRL0323	323.0 KM	2157.00	STRL0498	498.0 KM	3082.00	STRL0673	673.0 KM	3944.00
STRL0149	149.0 KM	1073.00	STRL0324	324.0 KM	2163.00	STRL0499	499.0 KM	3088.00	STRL0674	674.0 KM	3949.00
STRL0150	150.0 KM	1078.00	STRL0325	325.0 KM	2168.00	STRL0500	500.0 KM	3093.00	STRL0675	675.0 KM	3954.00
STRL0151	151.0 KM	1082.00	STRL0326	326.0 KM	2173.00	STRL0501	501.0 KM	3098.00	STRL0676	676.0 KM	3958.00
STRL0152	152.0 KM	1086.00	STRL0327	327.0 KM	2179.00	STRL0502	502.0 KM	3103.00	STRL0677	677.0 KM	3963.00

SAP Service code	Lead in KM	Rate/MT	SAP Service code	Lead in KM	Rate/MT	SAP Service code	Lead in KM	Rate/MT	SAP Service code	Lead in KM	Rate/MT
STRL0153	153.0 KM	1090.00	STRL0328	328.0 KM	2184.00	STRL0503	503.0 KM	3108.00	STRL0678	678.0 KM	3968.00
STRL0154	154.0 KM	1095.00	STRL0329	329.0 KM	2190.00	STRL0504	504.0 KM	3113.00	STRL0679	679.0 KM	3973.00
STRL0155	155.0 KM	1099.00	STRL0330	330.0 KM	2195.00	STRL0505	505.0 KM	3117.00	STRL0680	680.0 KM	3978.00
STRL0156	156.0 KM	1103.00	STRL0331	331.0 KM	2200.00	STRL0506	506.0 KM	3122.00	STRL0681	681.0 KM	3983.00
STRL0157	157.0 KM	1108.00	STRL0332	332.0 KM	2206.00	STRL0507	507.0 KM	3127.00	STRL0682	682.0 KM	3988.00
STRL0158	158.0 KM	1112.00	STRL0333	333.0 KM	2211.00	STRL0508	508.0 KM	3132.00	STRL0683	683.0 KM	3993.00
STRL0159	159.0 KM	1116.00	STRL0334	334.0 KM	2216.00	STRL0509	509.0 KM	3137.00	STRL0684	684.0 KM	3998.00
STRL0160	160.0 KM	1120.00	STRL0335	335.0 KM	2222.00	STRL0510	510.0 KM	3142.00	STRL0685	685.0 KM	4003.00
STRL0161	161.0 KM	1125.00	STRL0336	336.0 KM	2227.00	STRL0511	511.0 KM	3147.00	STRL0686	686.0 KM	4008.00
STRL0162	162.0 KM	1129.00	STRL0337	337.0 KM	2232.00	STRL0512	512.0 KM	3152.00	STRL0687	687.0 KM	4013.00
STRL0163	163.0 KM	1133.00	STRL0338	338.0 KM	2238.00	STRL0513	513.0 KM	3157.00	STRL0688	688.0 KM	4017.00
STRL0164	164.0 KM	1138.00	STRL0339	339.0 KM	2243.00	STRL0514	514.0 KM	3162.00	STRL0689	689.0 KM	4022.00
STRL0165	165.0 KM	1142.00	STRL0340	340.0 KM	2248.00	STRL0515	515.0 KM	3167.00	STRL0690	690.0 KM	4027.00
STRL0166	166.0 KM	1146.00	STRL0341	341.0 KM	2254.00	STRL0516	516.0 KM	3172.00	STRL0691	691.0 KM	4032.00
STRL0167	167.0 KM	1150.00	STRL0342	342.0 KM	2259.00	STRL0517	517.0 KM	3177.00	STRL0692	692.0 KM	4037.00
STRL0168	168.0 KM	1155.00	STRL0343	343.0 KM	2264.00	STRL0518	518.0 KM	3181.00	STRL0693	693.0 KM	4042.00
STRL0169	169.0 KM	1159.00	STRL0344	344.0 KM	2270.00	STRL0519	519.0 KM	3186.00	STRL0694	694.0 KM	4047.00
STRL0170	170.0 KM	1163.00	STRL0345	345.0 KM	2275.00	STRL0520	520.0 KM	3191.00	STRL0695	695.0 KM	4052.00
STRL0171	171.0 KM	1167.00	STRL0346	346.0 KM	2280.00	STRL0521	521.0 KM	3196.00	STRL0696	696.0 KM	4057.00
STRL0172	172.0 KM	1172.00	STRL0347	347.0 KM	2286.00	STRL0522	522.0 KM	3201.00	STRL0697	697.0 KM	4062.00
STRL0173	173.0 KM	1176.00	STRL0348	348.0 KM	2291.00	STRL0523	523.0 KM	3206.00	STRL0698	698.0 KM	4067.00
STRL0174	174.0 KM	1180.00	STRL0349	349.0 KM	2296.00	STRL0524	524.0 KM	3211.00	STRL0699	699.0 KM	4072.00
STRL0175	175.0 KM	1185.00	STRL0350	350.0 KM	2302.00	STRL0525	525.0 KM	3216.00	STRL0700	700.0 KM	4076.00

NOTE :

- a) Higher rates may be allowed in the marginal limits of slab.
- b) In respect of scattered works, and part loads, the above rates are applicable for working out load KM. This should be applied in the event of necessity for transport of part loads and where there is no scope for utilization of department lorries.

- c) Transport of conductor drums, transformer oil drums, and fragile materials such as kiosks, L.As, Insulators, Transformers, Meters etc., which occupy more space and less weight, the rates with 20% excess over the rates for line materials shall be adopted. Loading and unloading charges are payable extra.

4. Transport Of PSSC/Spun Poles:

a. Pole weights:.

Sl No	Type of pole	Weight in Kg/Pole
1	8m/140Kg PSSC pole	355 Kg
2	8m/200Kg PSSC pole	380 Kg
3	8m/300Kg PSSC pole	505 Kg
4	9.1m/280Kg PSSC pole	680 Kg
5	11m/365Kg PSSC Pole	1127Kg
6	9.5m/300Kg SPUN pole	620 Kg
7	11m/350Kg SPUN pole	900 Kg
8	12.5m/350Kg SPUN pole	1200 Kg

- b. **Transport by head loads:**.In case of hilly areas 30% extra is to be allowed for transport of poles by head loads.
- c. **Transport by bullock carts:**. Up to 8.0 KM, a rate of **Rs.121.00** per pole is to be adopted excluding loading and unloading charges.
- d. **Transport by lorries:-**The rates per Metric Tone are excluding the loading and unloading charges.

SAP Service code	Lead in KM	Rate/MT	SAP Service code	Lead in KM	Rate/MT	SAP Service code	Lead in KM	Rate/MT	SAP Service code	Lead in KM	Rate/MT
STRP0001	1.0 KM	284.00	STRP0176	176.0 KM	1668.00	STRP0351	351.0 KM	3163.00	STRP0526	526.0 KM	4458.00
STRP0002	2.0 KM	303.00	STRP0177	177.0 KM	1674.00	STRP0352	352.0 KM	3171.00	STRP0527	527.0 KM	4466.00
STRP0003	3.0 KM	313.00	STRP0178	178.0 KM	1681.00	STRP0353	353.0 KM	3178.00	STRP0528	528.0 KM	4473.00
STRP0004	4.0 KM	327.00	STRP0179	179.0 KM	1687.00	STRP0354	354.0 KM	3186.00	STRP0529	529.0 KM	4480.00
STRP0005	5.0 KM	338.00	STRP0180	180.0 KM	1693.00	STRP0355	355.0 KM	3194.00	STRP0530	530.0 KM	4487.00
STRP0006	6.0 KM	354.00	STRP0181	181.0 KM	1700.00	STRP0356	356.0 KM	3202.00	STRP0531	531.0 KM	4494.00
STRP0007	7.0 KM	367.00	STRP0182	182.0 KM	1706.00	STRP0357	357.0 KM	3210.00	STRP0532	532.0 KM	4501.00
STRP0008	8.0 KM	381.00	STRP0183	183.0 KM	1713.00	STRP0358	358.0 KM	3217.00	STRP0533	533.0 KM	4509.00
STRP0009	9.0 KM	396.00	STRP0184	184.0 KM	1719.00	STRP0359	359.0 KM	3225.00	STRP0534	534.0 KM	4516.00
STRP0010	10.0 KM	411.00	STRP0185	185.0 KM	1726.00	STRP0360	360.0 KM	3233.00	STRP0535	535.0 KM	4523.00
STRP0011	11.0 KM	426.00	STRP0186	186.0 KM	1732.00	STRP0361	361.0 KM	3241.00	STRP0536	536.0 KM	4530.00
STRP0012	12.0 KM	428.00	STRP0187	187.0 KM	1738.00	STRP0362	362.0 KM	3249.00	STRP0537	537.0 KM	4537.00
STRP0013	13.0 KM	431.00	STRP0188	188.0 KM	1745.00	STRP0363	363.0 KM	3256.00	STRP0538	538.0 KM	4544.00
STRP0014	14.0 KM	438.00	STRP0189	189.0 KM	1751.00	STRP0364	364.0 KM	3264.00	STRP0539	539.0 KM	4551.00
STRP0015	15.0 KM	459.00	STRP0190	190.0 KM	1758.00	STRP0365	365.0 KM	3272.00	STRP0540	540.0 KM	4559.00
STRP0016	16.0 KM	462.00	STRP0191	191.0 KM	1764.00	STRP0366	366.0 KM	3280.00	STRP0541	541.0 KM	4566.00
STRP0017	17.0 KM	464.00	STRP0192	192.0 KM	1770.00	STRP0367	367.0 KM	3288.00	STRP0542	542.0 KM	4573.00
STRP0018	18.0 KM	478.00	STRP0193	193.0 KM	1777.00	STRP0368	368.0 KM	3295.00	STRP0543	543.0 KM	4580.00
STRP0019	19.0 KM	491.00	STRP0194	194.0 KM	1783.00	STRP0369	369.0 KM	3303.00	STRP0544	544.0 KM	4587.00
STRP0020	20.0 KM	520.00	STRP0195	195.0 KM	1790.00	STRP0370	370.0 KM	3311.00	STRP0545	545.0 KM	4594.00
STRP0021	21.0 KM	530.00	STRP0196	196.0 KM	1796.00	STRP0371	371.0 KM	3319.00	STRP0546	546.0 KM	4602.00
STRP0022	22.0 KM	541.00	STRP0197	197.0 KM	1803.00	STRP0372	372.0 KM	3327.00	STRP0547	547.0 KM	4609.00
STRP0023	23.0 KM	551.00	STRP0198	198.0 KM	1809.00	STRP0373	373.0 KM	3334.00	STRP0548	548.0 KM	4616.00
STRP0024	24.0 KM	562.00	STRP0199	199.0 KM	1815.00	STRP0374	374.0 KM	3342.00	STRP0549	549.0 KM	4623.00
STRP0025	25.0 KM	573.00	STRP0200	200.0 KM	1822.00	STRP0375	375.0 KM	3350.00	STRP0550	550.0 KM	4630.00
STRP0026	26.0 KM	583.00	STRP0201	201.0 KM	1828.00	STRP0376	376.0 KM	3358.00	STRP0551	551.0 KM	4637.00
STRP0027	27.0 KM	594.00	STRP0202	202.0 KM	1835.00	STRP0377	377.0 KM	3366.00	STRP0552	552.0 KM	4645.00
STRP0028	28.0 KM	604.00	STRP0203	203.0 KM	1841.00	STRP0378	378.0 KM	3373.00	STRP0553	553.0 KM	4652.00
STRP0029	29.0 KM	615.00	STRP0204	204.0 KM	1847.00	STRP0379	379.0 KM	3381.00	STRP0554	554.0 KM	4659.00
STRP0030	30.0 KM	625.00	STRP0205	205.0 KM	1854.00	STRP0380	380.0 KM	3389.00	STRP0555	555.0 KM	4666.00
STRP0031	31.0 KM	634.00	STRP0206	206.0 KM	1860.00	STRP0381	381.0 KM	3397.00	STRP0556	556.0 KM	4673.00

SAP Service code	Lead in KM	Rate/MT	SAP Service code	Lead in KM	Rate/MT	SAP Service code	Lead in KM	Rate/MT	SAP Service code	Lead in KM	Rate/MT
STRP0032	32.0 KM	643.00	STRP0207	207.0 KM	1867.00	STRP0382	382.0 KM	3405.00	STRP0557	557.0 KM	4680.00
STRP0033	33.0 KM	652.00	STRP0208	208.0 KM	1873.00	STRP0383	383.0 KM	3412.00	STRP0558	558.0 KM	4688.00
STRP0034	34.0 KM	660.00	STRP0209	209.0 KM	1879.00	STRP0384	384.0 KM	3420.00	STRP0559	559.0 KM	4695.00
STRP0035	35.0 KM	669.00	STRP0210	210.0 KM	1886.00	STRP0385	385.0 KM	3428.00	STRP0560	560.0 KM	4702.00
STRP0036	36.0 KM	678.00	STRP0211	211.0 KM	1892.00	STRP0386	386.0 KM	3436.00	STRP0561	561.0 KM	4709.00
STRP0037	37.0 KM	687.00	STRP0212	212.0 KM	1899.00	STRP0387	387.0 KM	3444.00	STRP0562	562.0 KM	4716.00
STRP0038	38.0 KM	696.00	STRP0213	213.0 KM	1905.00	STRP0388	388.0 KM	3451.00	STRP0563	563.0 KM	4723.00
STRP0039	39.0 KM	704.00	STRP0214	214.0 KM	1912.00	STRP0389	389.0 KM	3459.00	STRP0564	564.0 KM	4731.00
STRP0040	40.0 KM	713.00	STRP0215	215.0 KM	1918.00	STRP0390	390.0 KM	3467.00	STRP0565	565.0 KM	4738.00
STRP0041	41.0 KM	722.00	STRP0216	216.0 KM	1924.00	STRP0391	391.0 KM	3475.00	STRP0566	566.0 KM	4745.00
STRP0042	42.0 KM	731.00	STRP0217	217.0 KM	1931.00	STRP0392	392.0 KM	3483.00	STRP0567	567.0 KM	4752.00
STRP0043	43.0 KM	739.00	STRP0218	218.0 KM	1937.00	STRP0393	393.0 KM	3491.00	STRP0568	568.0 KM	4759.00
STRP0044	44.0 KM	748.00	STRP0219	219.0 KM	1944.00	STRP0394	394.0 KM	3498.00	STRP0569	569.0 KM	4766.00
STRP0045	45.0 KM	757.00	STRP0220	220.0 KM	1950.00	STRP0395	395.0 KM	3506.00	STRP0570	570.0 KM	4774.00
STRP0046	46.0 KM	766.00	STRP0221	221.0 KM	1956.00	STRP0396	396.0 KM	3514.00	STRP0571	571.0 KM	4781.00
STRP0047	47.0 KM	774.00	STRP0222	222.0 KM	1963.00	STRP0397	397.0 KM	3522.00	STRP0572	572.0 KM	4788.00
STRP0048	48.0 KM	783.00	STRP0223	223.0 KM	1969.00	STRP0398	398.0 KM	3530.00	STRP0573	573.0 KM	4795.00
STRP0049	49.0 KM	792.00	STRP0224	224.0 KM	1976.00	STRP0399	399.0 KM	3537.00	STRP0574	574.0 KM	4802.00
STRP0050	50.0 KM	801.00	STRP0225	225.0 KM	1982.00	STRP0400	400.0 KM	3545.00	STRP0575	575.0 KM	4809.00
STRP0051	51.0 KM	809.00	STRP0226	226.0 KM	1989.00	STRP0401	401.0 KM	3552.00	STRP0576	576.0 KM	4817.00
STRP0052	52.0 KM	817.00	STRP0227	227.0 KM	1995.00	STRP0402	402.0 KM	3560.00	STRP0577	577.0 KM	4824.00
STRP0053	53.0 KM	825.00	STRP0228	228.0 KM	2001.00	STRP0403	403.0 KM	3567.00	STRP0578	578.0 KM	4831.00
STRP0054	54.0 KM	833.00	STRP0229	229.0 KM	2008.00	STRP0404	404.0 KM	3574.00	STRP0579	579.0 KM	4838.00
STRP0055	55.0 KM	841.00	STRP0230	230.0 KM	2014.00	STRP0405	405.0 KM	3581.00	STRP0580	580.0 KM	4845.00
STRP0056	56.0 KM	849.00	STRP0231	231.0 KM	2021.00	STRP0406	406.0 KM	3589.00	STRP0581	581.0 KM	4852.00
STRP0057	57.0 KM	857.00	STRP0232	232.0 KM	2027.00	STRP0407	407.0 KM	3596.00	STRP0582	582.0 KM	4859.00
STRP0058	58.0 KM	865.00	STRP0233	233.0 KM	2033.00	STRP0408	408.0 KM	3603.00	STRP0583	583.0 KM	4867.00
STRP0059	59.0 KM	873.00	STRP0234	234.0 KM	2040.00	STRP0409	409.0 KM	3611.00	STRP0584	584.0 KM	4874.00
STRP0060	60.0 KM	881.00	STRP0235	235.0 KM	2046.00	STRP0410	410.0 KM	3618.00	STRP0585	585.0 KM	4881.00
STRP0061	61.0 KM	889.00	STRP0236	236.0 KM	2053.00	STRP0411	411.0 KM	3625.00	STRP0586	586.0 KM	4888.00
STRP0062	62.0 KM	897.00	STRP0237	237.0 KM	2059.00	STRP0412	412.0 KM	3632.00	STRP0587	587.0 KM	4895.00

SAP Service code	Lead in KM	Rate/MT	SAP Service code	Lead in KM	Rate/MT	SAP Service code	Lead in KM	Rate/MT	SAP Service code	Lead in KM	Rate/MT
STRP0063	63.0 KM	905.00	STRP0238	238.0 KM	2066.00	STRP0413	413.0 KM	3640.00	STRP0588	588.0 KM	4902.00
STRP0064	64.0 KM	913.00	STRP0239	239.0 KM	2072.00	STRP0414	414.0 KM	3647.00	STRP0589	589.0 KM	4910.00
STRP0065	65.0 KM	921.00	STRP0240	240.0 KM	2078.00	STRP0415	415.0 KM	3654.00	STRP0590	590.0 KM	4917.00
STRP0066	66.0 KM	929.00	STRP0241	241.0 KM	2085.00	STRP0416	416.0 KM	3661.00	STRP0591	591.0 KM	4924.00
STRP0067	67.0 KM	937.00	STRP0242	242.0 KM	2091.00	STRP0417	417.0 KM	3669.00	STRP0592	592.0 KM	4931.00
STRP0068	68.0 KM	945.00	STRP0243	243.0 KM	2098.00	STRP0418	418.0 KM	3676.00	STRP0593	593.0 KM	4938.00
STRP0069	69.0 KM	953.00	STRP0244	244.0 KM	2104.00	STRP0419	419.0 KM	3683.00	STRP0594	594.0 KM	4945.00
STRP0070	70.0 KM	961.00	STRP0245	245.0 KM	2110.00	STRP0420	420.0 KM	3691.00	STRP0595	595.0 KM	4953.00
STRP0071	71.0 KM	969.00	STRP0246	246.0 KM	2117.00	STRP0421	421.0 KM	3698.00	STRP0596	596.0 KM	4960.00
STRP0072	72.0 KM	977.00	STRP0247	247.0 KM	2123.00	STRP0422	422.0 KM	3705.00	STRP0597	597.0 KM	4967.00
STRP0073	73.0 KM	985.00	STRP0248	248.0 KM	2130.00	STRP0423	423.0 KM	3712.00	STRP0598	598.0 KM	4974.00
STRP0074	74.0 KM	993.00	STRP0249	249.0 KM	2136.00	STRP0424	424.0 KM	3720.00	STRP0599	599.0 KM	4981.00
STRP0075	75.0 KM	1001.00	STRP0250	250.0 KM	2142.00	STRP0425	425.0 KM	3727.00	STRP0600	600.0 KM	4988.00
STRP0076	76.0 KM	1009.00	STRP0251	251.0 KM	2372.00	STRP0426	426.0 KM	3734.00	STRP0601	601.0 KM	4996.00
STRP0077	77.0 KM	1017.00	STRP0252	252.0 KM	2380.00	STRP0427	427.0 KM	3741.00	STRP0602	602.0 KM	5003.00
STRP0078	78.0 KM	1025.00	STRP0253	253.0 KM	2388.00	STRP0428	428.0 KM	3749.00	STRP0603	603.0 KM	5010.00
STRP0079	79.0 KM	1033.00	STRP0254	254.0 KM	2396.00	STRP0429	429.0 KM	3756.00	STRP0604	604.0 KM	5017.00
STRP0080	80.0 KM	1041.00	STRP0255	255.0 KM	2404.00	STRP0430	430.0 KM	3763.00	STRP0605	605.0 KM	5024.00
STRP0081	81.0 KM	1048.00	STRP0256	256.0 KM	2412.00	STRP0431	431.0 KM	3771.00	STRP0606	606.0 KM	5031.00
STRP0082	82.0 KM	1055.00	STRP0257	257.0 KM	2420.00	STRP0432	432.0 KM	3778.00	STRP0607	607.0 KM	5039.00
STRP0083	83.0 KM	1062.00	STRP0258	258.0 KM	2428.00	STRP0433	433.0 KM	3785.00	STRP0608	608.0 KM	5046.00
STRP0084	84.0 KM	1069.00	STRP0259	259.0 KM	2436.00	STRP0434	434.0 KM	3792.00	STRP0609	609.0 KM	5053.00
STRP0085	85.0 KM	1076.00	STRP0260	260.0 KM	2444.00	STRP0435	435.0 KM	3800.00	STRP0610	610.0 KM	5060.00
STRP0086	86.0 KM	1083.00	STRP0261	261.0 KM	2452.00	STRP0436	436.0 KM	3807.00	STRP0611	611.0 KM	5067.00
STRP0087	87.0 KM	1090.00	STRP0262	262.0 KM	2460.00	STRP0437	437.0 KM	3814.00	STRP0612	612.0 KM	5074.00
STRP0088	88.0 KM	1097.00	STRP0263	263.0 KM	2468.00	STRP0438	438.0 KM	3821.00	STRP0613	613.0 KM	5082.00
STRP0089	89.0 KM	1104.00	STRP0264	264.0 KM	2476.00	STRP0439	439.0 KM	3829.00	STRP0614	614.0 KM	5089.00
STRP0090	90.0 KM	1111.00	STRP0265	265.0 KM	2484.00	STRP0440	440.0 KM	3836.00	STRP0615	615.0 KM	5096.00
STRP0091	91.0 KM	1118.00	STRP0266	266.0 KM	2492.00	STRP0441	441.0 KM	3843.00	STRP0616	616.0 KM	5103.00
STRP0092	92.0 KM	1125.00	STRP0267	267.0 KM	2500.00	STRP0442	442.0 KM	3850.00	STRP0617	617.0 KM	5110.00
STRP0093	93.0 KM	1132.00	STRP0268	268.0 KM	2508.00	STRP0443	443.0 KM	3858.00	STRP0618	618.0 KM	5117.00

SAP Service code	Lead in KM	Rate/MT	SAP Service code	Lead in KM	Rate/MT	SAP Service code	Lead in KM	Rate/MT	SAP Service code	Lead in KM	Rate/MT
STRP0094	94.0 KM	1139.00	STRP0269	269.0 KM	2516.00	STRP0444	444.0 KM	3865.00	STRP0619	619.0 KM	5125.00
STRP0095	95.0 KM	1146.00	STRP0270	270.0 KM	2524.00	STRP0445	445.0 KM	3872.00	STRP0620	620.0 KM	5132.00
STRP0096	96.0 KM	1152.00	STRP0271	271.0 KM	2532.00	STRP0446	446.0 KM	3880.00	STRP0621	621.0 KM	5139.00
STRP0097	97.0 KM	1159.00	STRP0272	272.0 KM	2540.00	STRP0447	447.0 KM	3887.00	STRP0622	622.0 KM	5146.00
STRP0098	98.0 KM	1166.00	STRP0273	273.0 KM	2548.00	STRP0448	448.0 KM	3894.00	STRP0623	623.0 KM	5153.00
STRP0099	99.0 KM	1173.00	STRP0274	274.0 KM	2556.00	STRP0449	449.0 KM	3901.00	STRP0624	624.0 KM	5160.00
STRP0100	100.0 KM	1180.00	STRP0275	275.0 KM	2564.00	STRP0450	450.0 KM	3909.00	STRP0625	625.0 KM	5167.00
STRP0101	101.0 KM	1187.00	STRP0276	276.0 KM	2572.00	STRP0451	451.0 KM	3916.00	STRP0626	626.0 KM	5175.00
STRP0102	102.0 KM	1193.00	STRP0277	277.0 KM	2580.00	STRP0452	452.0 KM	3923.00	STRP0627	627.0 KM	5182.00
STRP0103	103.0 KM	1200.00	STRP0278	278.0 KM	2588.00	STRP0453	453.0 KM	3930.00	STRP0628	628.0 KM	5189.00
STRP0104	104.0 KM	1206.00	STRP0279	279.0 KM	2596.00	STRP0454	454.0 KM	3938.00	STRP0629	629.0 KM	5196.00
STRP0105	105.0 KM	1212.00	STRP0280	280.0 KM	2604.00	STRP0455	455.0 KM	3945.00	STRP0630	630.0 KM	5203.00
STRP0106	106.0 KM	1219.00	STRP0281	281.0 KM	2612.00	STRP0456	456.0 KM	3952.00	STRP0631	631.0 KM	5210.00
STRP0107	107.0 KM	1225.00	STRP0282	282.0 KM	2620.00	STRP0457	457.0 KM	3960.00	STRP0632	632.0 KM	5218.00
STRP0108	108.0 KM	1232.00	STRP0283	283.0 KM	2628.00	STRP0458	458.0 KM	3967.00	STRP0633	633.0 KM	5225.00
STRP0109	109.0 KM	1238.00	STRP0284	284.0 KM	2636.00	STRP0459	459.0 KM	3974.00	STRP0634	634.0 KM	5232.00
STRP0110	110.0 KM	1244.00	STRP0285	285.0 KM	2644.00	STRP0460	460.0 KM	3981.00	STRP0635	635.0 KM	5239.00
STRP0111	111.0 KM	1251.00	STRP0286	286.0 KM	2652.00	STRP0461	461.0 KM	3989.00	STRP0636	636.0 KM	5246.00
STRP0112	112.0 KM	1257.00	STRP0287	287.0 KM	2660.00	STRP0462	462.0 KM	3996.00	STRP0637	637.0 KM	5253.00
STRP0113	113.0 KM	1264.00	STRP0288	288.0 KM	2668.00	STRP0463	463.0 KM	4003.00	STRP0638	638.0 KM	5261.00
STRP0114	114.0 KM	1270.00	STRP0289	289.0 KM	2676.00	STRP0464	464.0 KM	4010.00	STRP0639	639.0 KM	5268.00
STRP0115	115.0 KM	1277.00	STRP0290	290.0 KM	2685.00	STRP0465	465.0 KM	4018.00	STRP0640	640.0 KM	5275.00
STRP0116	116.0 KM	1283.00	STRP0291	291.0 KM	2693.00	STRP0466	466.0 KM	4025.00	STRP0641	641.0 KM	5282.00
STRP0117	117.0 KM	1289.00	STRP0292	292.0 KM	2701.00	STRP0467	467.0 KM	4032.00	STRP0642	642.0 KM	5289.00
STRP0118	118.0 KM	1296.00	STRP0293	293.0 KM	2709.00	STRP0468	468.0 KM	4039.00	STRP0643	643.0 KM	5296.00
STRP0119	119.0 KM	1302.00	STRP0294	294.0 KM	2717.00	STRP0469	469.0 KM	4047.00	STRP0644	644.0 KM	5304.00
STRP0120	120.0 KM	1309.00	STRP0295	295.0 KM	2725.00	STRP0470	470.0 KM	4054.00	STRP0645	645.0 KM	5311.00
STRP0121	121.0 KM	1315.00	STRP0296	296.0 KM	2733.00	STRP0471	471.0 KM	4061.00	STRP0646	646.0 KM	5318.00
STRP0122	122.0 KM	1321.00	STRP0297	297.0 KM	2741.00	STRP0472	472.0 KM	4069.00	STRP0647	647.0 KM	5325.00
STRP0123	123.0 KM	1328.00	STRP0298	298.0 KM	2749.00	STRP0473	473.0 KM	4076.00	STRP0648	648.0 KM	5332.00
STRP0124	124.0 KM	1334.00	STRP0299	299.0 KM	2757.00	STRP0474	474.0 KM	4083.00	STRP0649	649.0 KM	5339.00

SAP Service code	Lead in KM	Rate/MT	SAP Service code	Lead in KM	Rate/MT	SAP Service code	Lead in KM	Rate/MT	SAP Service code	Lead in KM	Rate/MT
STRP0125	125.0 KM	1341.00	STRP0300	300.0 KM	2765.00	STRP0475	475.0 KM	4090.00	STRP0650	650.0 KM	5347.00
STRP0126	126.0 KM	1347.00	STRP0301	301.0 KM	2772.00	STRP0476	476.0 KM	4098.00	STRP0651	651.0 KM	5354.00
STRP0127	127.0 KM	1353.00	STRP0302	302.0 KM	2780.00	STRP0477	477.0 KM	4105.00	STRP0652	652.0 KM	5361.00
STRP0128	128.0 KM	1360.00	STRP0303	303.0 KM	2788.00	STRP0478	478.0 KM	4112.00	STRP0653	653.0 KM	5368.00
STRP0129	129.0 KM	1366.00	STRP0304	304.0 KM	2796.00	STRP0479	479.0 KM	4119.00	STRP0654	654.0 KM	5375.00
STRP0130	130.0 KM	1373.00	STRP0305	305.0 KM	2804.00	STRP0480	480.0 KM	4127.00	STRP0655	655.0 KM	5382.00
STRP0131	131.0 KM	1379.00	STRP0306	306.0 KM	2812.00	STRP0481	481.0 KM	4134.00	STRP0656	656.0 KM	5390.00
STRP0132	132.0 KM	1386.00	STRP0307	307.0 KM	2819.00	STRP0482	482.0 KM	4141.00	STRP0657	657.0 KM	5397.00
STRP0133	133.0 KM	1392.00	STRP0308	308.0 KM	2827.00	STRP0483	483.0 KM	4149.00	STRP0658	658.0 KM	5404.00
STRP0134	134.0 KM	1398.00	STRP0309	309.0 KM	2835.00	STRP0484	484.0 KM	4156.00	STRP0659	659.0 KM	5411.00
STRP0135	135.0 KM	1405.00	STRP0310	310.0 KM	2843.00	STRP0485	485.0 KM	4163.00	STRP0660	660.0 KM	5418.00
STRP0136	136.0 KM	1411.00	STRP0311	311.0 KM	2851.00	STRP0486	486.0 KM	4170.00	STRP0661	661.0 KM	5425.00
STRP0137	137.0 KM	1418.00	STRP0312	312.0 KM	2858.00	STRP0487	487.0 KM	4178.00	STRP0662	662.0 KM	5433.00
STRP0138	138.0 KM	1424.00	STRP0313	313.0 KM	2866.00	STRP0488	488.0 KM	4185.00	STRP0663	663.0 KM	5440.00
STRP0139	139.0 KM	1430.00	STRP0314	314.0 KM	2874.00	STRP0489	489.0 KM	4192.00	STRP0664	664.0 KM	5447.00
STRP0140	140.0 KM	1437.00	STRP0315	315.0 KM	2882.00	STRP0490	490.0 KM	4199.00	STRP0665	665.0 KM	5454.00
STRP0141	141.0 KM	1443.00	STRP0316	316.0 KM	2890.00	STRP0491	491.0 KM	4207.00	STRP0666	666.0 KM	5461.00
STRP0142	142.0 KM	1450.00	STRP0317	317.0 KM	2897.00	STRP0492	492.0 KM	4214.00	STRP0667	667.0 KM	5468.00
STRP0143	143.0 KM	1456.00	STRP0318	318.0 KM	2905.00	STRP0493	493.0 KM	4221.00	STRP0668	668.0 KM	5476.00
STRP0144	144.0 KM	1463.00	STRP0319	319.0 KM	2913.00	STRP0494	494.0 KM	4229.00	STRP0669	669.0 KM	5483.00
STRP0145	145.0 KM	1469.00	STRP0320	320.0 KM	2921.00	STRP0495	495.0 KM	4236.00	STRP0670	670.0 KM	5490.00
STRP0146	146.0 KM	1475.00	STRP0321	321.0 KM	2929.00	STRP0496	496.0 KM	4243.00	STRP0671	671.0 KM	5497.00
STRP0147	147.0 KM	1482.00	STRP0322	322.0 KM	2936.00	STRP0497	497.0 KM	4250.00	STRP0672	672.0 KM	5504.00
STRP0148	148.0 KM	1488.00	STRP0323	323.0 KM	2944.00	STRP0498	498.0 KM	4258.00	STRP0673	673.0 KM	5511.00
STRP0149	149.0 KM	1495.00	STRP0324	324.0 KM	2952.00	STRP0499	499.0 KM	4265.00	STRP0674	674.0 KM	5518.00
STRP0150	150.0 KM	1501.00	STRP0325	325.0 KM	2960.00	STRP0500	500.0 KM	4272.00	STRP0675	675.0 KM	5526.00
STRP0151	151.0 KM	1507.00	STRP0326	326.0 KM	2968.00	STRP0501	501.0 KM	4279.00	STRP0676	676.0 KM	5533.00
STRP0152	152.0 KM	1514.00	STRP0327	327.0 KM	2975.00	STRP0502	502.0 KM	4286.00	STRP0677	677.0 KM	5540.00
STRP0153	153.0 KM	1520.00	STRP0328	328.0 KM	2983.00	STRP0503	503.0 KM	4294.00	STRP0678	678.0 KM	5547.00
STRP0154	154.0 KM	1527.00	STRP0329	329.0 KM	2991.00	STRP0504	504.0 KM	4301.00	STRP0679	679.0 KM	5554.00
STRP0155	155.0 KM	1533.00	STRP0330	330.0 KM	2999.00	STRP0505	505.0 KM	4308.00	STRP0680	680.0 KM	5561.00

SAP Service code	Lead in KM	Rate/MT	SAP Service code	Lead in KM	Rate/MT	SAP Service code	Lead in KM	Rate/MT	SAP Service code	Lead in KM	Rate/MT
STRP0156	156.0 KM	1540.00	STRP0331	331.0 KM	3007.00	STRP0506	506.0 KM	4315.00	STRP0681	681.0 KM	5569.00
STRP0157	157.0 KM	1546.00	STRP0332	332.0 KM	3014.00	STRP0507	507.0 KM	4322.00	STRP0682	682.0 KM	5576.00
STRP0158	158.0 KM	1552.00	STRP0333	333.0 KM	3022.00	STRP0508	508.0 KM	4329.00	STRP0683	683.0 KM	5583.00
STRP0159	159.0 KM	1559.00	STRP0334	334.0 KM	3030.00	STRP0509	509.0 KM	4337.00	STRP0684	684.0 KM	5590.00
STRP0160	160.0 KM	1565.00	STRP0335	335.0 KM	3038.00	STRP0510	510.0 KM	4344.00	STRP0685	685.0 KM	5597.00
STRP0161	161.0 KM	1572.00	STRP0336	336.0 KM	3046.00	STRP0511	511.0 KM	4351.00	STRP0686	686.0 KM	5604.00
STRP0162	162.0 KM	1578.00	STRP0337	337.0 KM	3053.00	STRP0512	512.0 KM	4358.00	STRP0687	687.0 KM	5612.00
STRP0163	163.0 KM	1584.00	STRP0338	338.0 KM	3061.00	STRP0513	513.0 KM	4365.00	STRP0688	688.0 KM	5619.00
STRP0164	164.0 KM	1591.00	STRP0339	339.0 KM	3069.00	STRP0514	514.0 KM	4372.00	STRP0689	689.0 KM	5626.00
STRP0165	165.0 KM	1597.00	STRP0340	340.0 KM	3077.00	STRP0515	515.0 KM	4380.00	STRP0690	690.0 KM	5633.00
STRP0166	166.0 KM	1604.00	STRP0341	341.0 KM	3085.00	STRP0516	516.0 KM	4387.00	STRP0691	691.0 KM	5640.00
STRP0167	167.0 KM	1610.00	STRP0342	342.0 KM	3092.00	STRP0517	517.0 KM	4394.00	STRP0692	692.0 KM	5647.00
STRP0168	168.0 KM	1616.00	STRP0343	343.0 KM	3100.00	STRP0518	518.0 KM	4401.00	STRP0693	693.0 KM	5655.00
STRP0169	169.0 KM	1623.00	STRP0344	344.0 KM	3108.00	STRP0519	519.0 KM	4408.00	STRP0694	694.0 KM	5662.00
STRP0170	170.0 KM	1629.00	STRP0345	345.0 KM	3116.00	STRP0520	520.0 KM	4415.00	STRP0695	695.0 KM	5669.00
STRP0171	171.0 KM	1636.00	STRP0346	346.0 KM	3124.00	STRP0521	521.0 KM	4423.00	STRP0696	696.0 KM	5676.00
STRP0172	172.0 KM	1642.00	STRP0347	347.0 KM	3132.00	STRP0522	522.0 KM	4430.00	STRP0697	697.0 KM	5683.00
STRP0173	173.0 KM	1649.00	STRP0348	348.0 KM	3139.00	STRP0523	523.0 KM	4437.00	STRP0698	698.0 KM	5690.00
STRP0174	174.0 KM	1655.00	STRP0349	349.0 KM	3147.00	STRP0524	524.0 KM	4444.00	STRP0699	699.0 KM	5698.00
STRP0175	175.0 KM	1661.00	STRP0350	350.0 KM	3155.00	STRP0525	525.0 KM	4451.00	STRP0700	700.0 KM	5705.00

Security fencing with gates & locking arrangement and one side removable fencing, three sides fixed fencing to DTRs.

PLAN

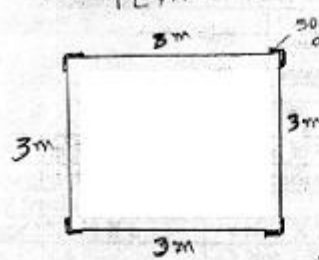

ISOMETRIC VIEW

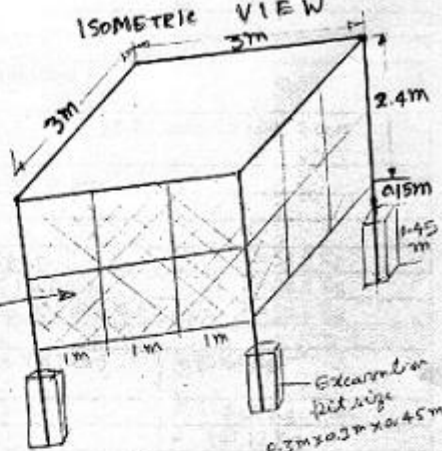

All four sides GI chain link mesh of 8 gauge of size 50.8mm x 50.8mm (2" x 2") to be welded fixed

Elevation of detachable fencing (one side)

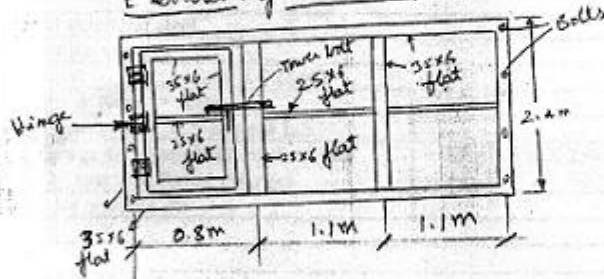

Elevation of fixed fencing (Three sides)

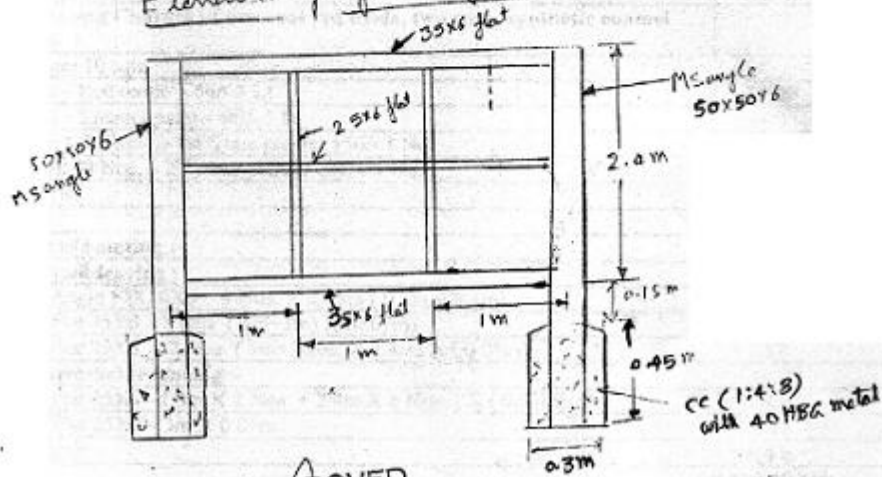

APPROVED
 CHIEF GENERAL MANAGER
 Operations & R & M
 APSPCL, TIRUPATI

P. T. Jaganmud
 ADF/c

e.